



TUMBLE
DRYERS

GREEN
EVOLUTION

FAGOR 
FAGOR INDUSTRIAL



FD 25-35-50 GREEN EVOLUTION

THE PERFECT BALANCE BETWEEN
QUALITY AND PRICE.

Mixed
Flow

MP
Control

Autoreverse
DRUM

Stainless
Steel DRUM

SOFT
TOUCH

FEATURES

- Auto-reverse Drum: the drying process is more efficient; offers better uniformity; avoiding the tangling of big pieces.
- Frequency inverter: controls rotating speed and reverse drum action.
- Filter drawer with wide surface and improved airflow made of stainless steel.
- Outer casing in grey skin-plate, stainless steel look.
- Stainless Steel Drum.
- 3 different ranges:
 - "MP Control" range: easy and intuitive electronic control offers a complete control of the process: possibility to select required drum speed, statistics control, technical menu, alarms, etc. 10 standard programs that can be modified.
 - "M Control" range: easy to use analogic control with time and temperature selection.
 - "Self-Service" range: specific MP control for the self-service industry with several payment options: central payment, coin/token or with prepaid card systems.
- Soft Touch: the stamped drum perforations make sure the liner is gently handled, lengthening the garments lifetime.
- Mixed Flow: the system of mixed axial-radial airflow increases the efficiency of the whole drying process due to the improvement of the air-flow inside the drum.
- Big loading door (opening of 180°).
- Transmission of movement by gear motor (direct drive).
- Cool Down: anti-wrinkle at the end of cycle.

Models available in electric, gas or steam heating.

OPTIONS:

- iDRY (MP Control models only): humidity sensor that offers a precise humidity control; by this system the drying cycle will automatically stop when it reaches the set level of residual humidity.
- Fire Care System (MP Control models only).
- Double door-glass.
- Stainless steel body.
- Stainless steel front panel.
- Low pressure steam battery.
- Model versions in 60 Hz.
- Marine versions 440V III 50/60 Hz No neutral or 480V III 50/60 Hz No neutral.



FAGOR COMMERCIAL, INC.

13105 NW 47th Ave
Opa-locka 33054

Phone (305) 779 0170
us.marketing@onnergroupp.com



www.fagorcommercial.com

TECHNICAL DATA	UNIT.	FD- 25	FD - 35	FD- 50			
CAPACITY							
Capacity 1/18	lb	26	40	60			
Capacity 1/20	lb	25	35	50			
Hourly Output *	lb/h	62/ 6	68 / 9	88 / 6			
Evaporation Capacity *	l/h	14,5	16,3	20,4			
DRUM							
Ø Drum	in	29.50	29.50	33			
Ø Door	in	22.50	22.50	22.50			
Door Center Height	in	38.50	38.50	40.50			
Door Bottom Height	in	27	27	29.25			
Drum Depth	in	18.70	29.30	31.50			
Drum Volume	CuFt	7	12	17			
POWER							
Drum motor power	HP	1	1	1			
Fan motor power	HP	0.33	0.33	0,75			
Electric heating power	kw	16	24	32			
Total electric power (elec.model)	kw	16.99	25.03	33.48			
Gas heating power	BTU	93,834	93,834	141,843			
Total electric power (gas model)	kw	0.89	0.89	1.3			
Steam heating power	kw	40	40	66			
Steam heating power (gas model)	kw	0.89	0,89	1.3			
CONNECTIONS		ELECTRICAL	STEAM / GAS	ELECTRICAL	STEAM / GAS	ELECTRICAL	STEAM / GAS
Tension 120 V - I / 230V - I + N + T	Nº x mm2 / A	3 x 35 / 63A	3 x 1,5 / 20A	-	3 x 1,5 / 20A	-	3 x 1,5 / 20A
Tension 230V - III + T	Nº x mm2 / A	4 x 10 / 40A	3 x 1,5 / 20A	4 x 16 / 63A	3 x 1,5 / 20A	4 x 25 / 80A	3 x 1,5 / 20A
Tension 400V - III + N + T	Nº x mm2 / A	5 x 4 / 25A	3 x 1,5 / 20A	5 x 10 / 32A	3 x 1,5 / 20A	5 x 10 / 40A	3 x 1,5 / 20A
Ø Gas inlet	BSP	1/2"		1/2"		1/2"	
Ø Steam inlet	BSP	3/4"		3/4"		1"	
Ø Condensed (Steam models)	BSP	3/4"		3/4"		1"	
DIMENSIONS / PACKING DIMENSIONS							
Net Width / Gross Width	in	31 / 34		31 / 34		35 / 38	
Net Depth / Gross Depth	in	33 / 37		44 / 48		49 / 53	
Net Height / Gross Height	in	67 / 73		67 / 73		71 / 76	
Height without heating battery	in	-		-		-	
Net weight / Gross weight	lb	379 / 396		412 / 440		462 / 485	
OTHERS							
Max airflow	CFM	500		500		706	
Ø Duct Size	in	8		8		8	
Sound level	dB	64		64		65	

* It may vary depending on the type of heating, filter cleanliness or extraction type.

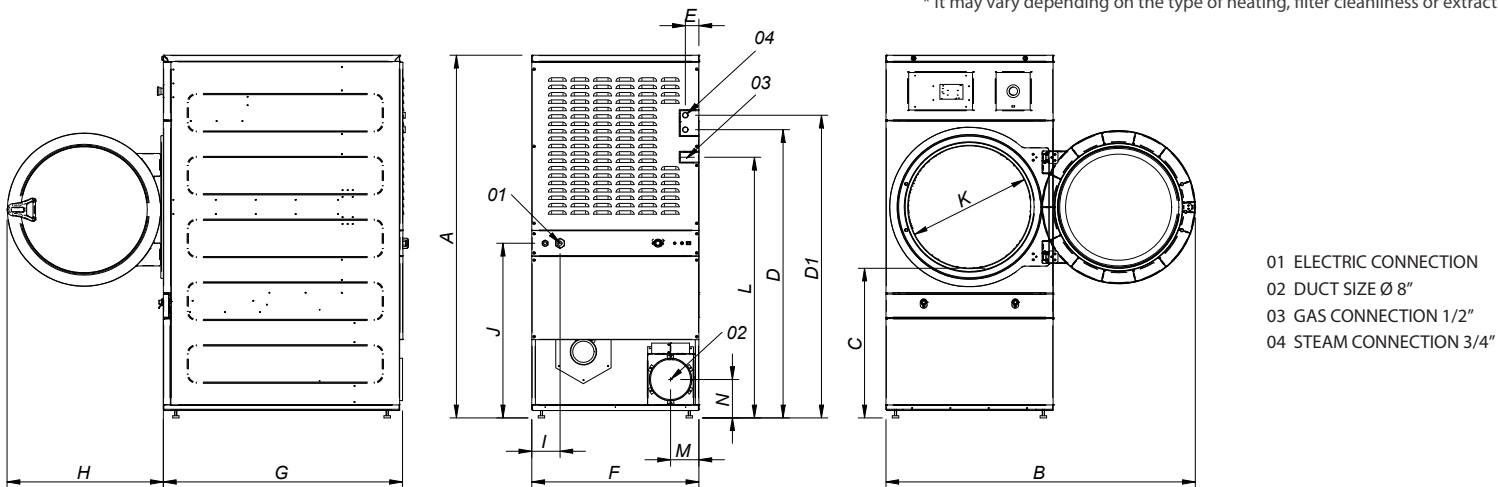

	A	B	C	D	D1	E	F	G	H	I	J	K	L	M	N
FD-25	67	57	27	54	56	3	31	34	29	3.75	33	23	48.25	5.25	7
FD-35	67	57	27	54	56	3	31	44.25	29	3.75	33	23	48.25	5.25	7
FD-50	71	61	29.25	56.25	60.25	4.50	35	49.50	29	8	34	23	53	5.25	7



TUMBLE
DRYERS

GREEN
EVOLUTION

FAGOR 
FAGOR INDUSTRIAL



FD 65-80 GREEN EVOLUTION

THE PERFECT BALANCE BETWEEN
QUALITY AND PRICE.

Mixed
Flow

MP
Control

Autoreverse
DRUM

Stainless
Steel DRUM

SOFT
TOUCH

FEATURES

- Auto-reverse Drum: the drying process is more efficient; offers better uniformity; avoiding the tangling of big pieces.
- Frequency inverter: controls rotating speed and reverse drum action.
- Filter drawer with wide surface and improved airflow made of stainless steel.
- Outer casing in grey skin-plate, stainless steel look.
- Stainless Steel Drum.
- 3 different ranges:
 - "MP Control" range: easy and intuitive electronic control offers a complete control of the process: possibility to select required drum speed, statistics control, technical menu, alarms, etc. 10 standard programs that can be modified.
 - "M Control" range: easy to use analogic control with time and temperature selection.
 - "Self-Service" range: specific MP control for the self-service industry with several payment options: central payment, coin/token or with prepaid card systems.
- Soft Touch: the stamped drum perforations make sure the liner is gently handled, lengthening the garments lifetime.
- Mixed Flow: the system of mixed axial-radial airflow increases the efficiency of the whole drying process due to the improvement of the air-flow inside the drum.
- Big loading door (opening of 180°).
- Transmission of movement by gear motor (direct drive).
- Cool Down: anti-wrinkle at the end of cycle.

Models available in electric,
gas or steam heating.

OPTIONS:

- iDRY (MP Control models only): humidity sensor that offers a precise humidity control; by this system the drying cycle will automatically stop when it reaches the set level of residual humidity.
- Fire Care System (MP Control models only).
- Double door-glass.
- Stainless steel body.
- Stainless steel front panel.
- Low pressure steam battery.
- Model versions in 60 Hz.
- Marine versions 440V III 50/60 Hz No neutral or 480V III 50/60 Hz No neutral.



www.fagorcommercial.com

FAGOR COMMERCIAL, INC.

13105 NW 47th Ave
Opa-locka 33054

Phone (305) 779 0170
us.marketing@onnergroupp.com



TECHNICAL DATA		UNIT.	FD- 65		FD- 80	
CAPACITY						
Capacity 1/18	lb	70		80		
Capacity 1/20	lb	60		75		
Hourly Output *	lb/h	59,3		138 / 9		
Evaporation capacity *	l/h	30,9		32,1		
DRUM						
Ø Drum	in	37.25		37.25		
Ø Door	in	31.50		31.50		
Door center height	in	41		41		
Load hole bottom height	in	64.50		64.50		
Drum length	in	30.75		36.85		
Drum volume	CðFt	19		23		
POWER						
Drum motor power	HP	0,75		0,75		
Fan motor power	HP	0,75		0,75		
Electric heating power	Kw	30		36		
Total electric power (elec.model)	Kw	31,15		37,15		
Gas heating power	BTU	139898		139898		
Total electric power (gas model)	Kw	1,15		1,15		
Steam heating power	kw	50,1		50,1		
Steam heating power (gas model)	kw	1,15		1,15		
CONNECTIONS		ELECTRICAL		STEAM / GAS		
Tension 120 V - I / 230V - I + N + T	Nº x mm2 / A	-		3 x 1,5 / 20A		
Tension 230V - III + T	Nº x mm2 / A	4 x 35 / 100A		3 x 1,5 / 20A		
Tension 400V - III + N + T	Nº x mm2 / A	5 x 16 / 63A		3 x 1,5 / 20A		
Ø Gas inlet	BSP	1/2"		1/2"		
Ø Steam inlet	BSP	1"		1"		
Ø Condensed (Steam models)	BSP	1"		1"		
DIMENSIONS / PACKING DIMENSIONS						
Net Width / Gross Width	in	38.75 / 42		38.75 / 42		
Net Depth / Gross Depth	in	41.50 / 45.50		47.60 / 51.60		
Net Height / Gross Height	in	76.60 / 82		76.60 / 82		
Height without heating battery	in	-		-		
Net weight / Gross weight	lb	507 / 573		573 / 628		
OTHERS						
Max airflow	CFM	706		706		
Ø Duct Size	in	8		8		
Sound level	dB	65		65		

* It may vary depending on the type of heating, filter cleanliness or extraction type.

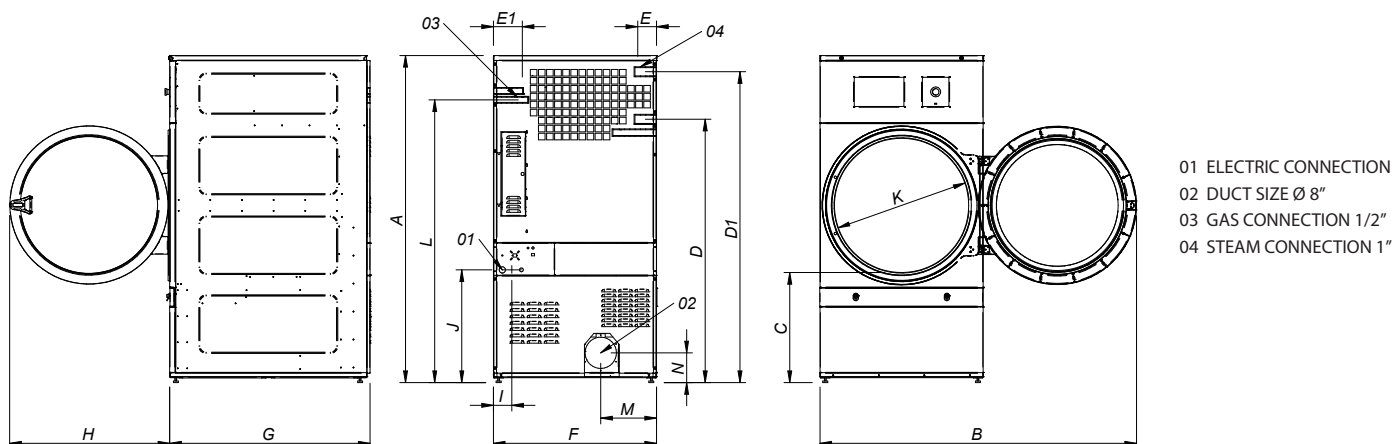

	A	B	C	D	D1	E	E1	F	G	H	I	J	K	L	M	N
FD-65	76.60	75	25	62.60	74	4.50	6.85	38.75	41.50	37.75	4.30	26.75	31.60	67.25	13.35	7
FD-80	76.60	75	25	62.60	74	4.50	6.85	38.75	47.60	37.75	4.30	26.75	31.60	67.25	13.35	7





TUMBLE
DRYERS

GREEN
EVOLUTION

FAGOR 
FAGOR INDUSTRIAL



FD PLUS 25-35-50 GREEN EVOLUTION

THE PERFECT BALANCE BETWEEN
QUALITY AND PRICE.

Mixed
Flow

MP
Control

Autoreverse
DRUM

Stainless
Steel DRUM

SOFT
TOUCH

FEATURES

- Auto-reverse Drum: the drying process is more efficient; offers better uniformity, avoiding the tangling of big pieces.
- Frequency inverter: controls rotating speed and reverse drum action.
- Filter drawer with wide surface and improved airflow made of stainless steel.
- Outer casing in grey skin-plate, stainless steel look.
- Stainless Steel Drum.
- "MP Control" range: easy and intuitive electronic control offers a complete control of the process: possibility to select required drum speed, statistics control, technical menu, alarms, etc. 10 standard programs that can be modified.
- Soft Touch: the stamped drum perforations make sure the liner is gently handled, lengthening the garments lifetime.
- Total Flow: optimized mixed axial-radial flow through further openings and back-of-the-drum air reintroduction.
- iDRY: humidity sensor that offers a precise humidity control; by this system the drying cycle will automatically stop when it reaches the set level of residual humidity.
- Fire Care System.
- Green Flow System: recirculation system that reintroduces the expelled hot air inside the drum.
- Insulated Panels: complete circuit of the air-flow has been thermally insulated (panels, double door-glass, recirculation duct).
- Big loading door (opening of 180°).
- Transmission of movement by gear motor (direct drive).
- Cool Down: anti-wrinkle at the end of cycle.

Models available in electric,
gas or steam heating.

OPTIONS:

- Stainless steel body.
- Stainless steel front panel.
- Low pressure steam battery.
- Model versions in 60 Hz.
- Marine versions 440V III 50/60 Hz
No neutral or 480V III 50/60 Hz



www.fagorcommercial.com

FAGOR COMMERCIAL, INC.

13105 NW 47th Ave
Opa-locka 33054

Phone (305) 779 0170
us.marketing@onnergroupp.com



TECHNICAL DATA		UNIT.	FD PLUS- 25		FD PLUS - 35		FD PLUS- 50	
CAPACITY								
Capacity 1/18	lb	26		40		60		
Capacity 1/20	lb	25		35		50		
Hourly Output *	lb/h	62/ 6		68 / 9		88 / 6		
Evaporation Capacity *	l/h	14,5		16,3		20,4		
DRUM								
Ø Drum	in	29.50		29.50		33		
Ø Door	in	22.50		22.50		22.50		
Door Center Height	in	38.50		38.50		40.50		
Door Bottom Height	in	27		27		29.25		
Drum Depth	in	18.70		29.30		31.50		
Drum Volume	CuFt	7		12		17		
POWER								
Drum motor power	HP	1		1		1		
Fan motor power	HP	0.33		0.33		0,75		
Electric heating power	kw	16		24		32		
Total electric power (elec.model)	kw	16.99		25.03		33.48		
Gas heating power	BTU	93,834		93,834		141,843		
Total electric power (gas model)	kw	0.89		0.89		1.3		
Steam heating power	kw	40		40		66		
Steam heating power (gas model)	kw	0.89		0,89		1.3		
CONNECTIONS		ELECTRICAL	STEAM / GAS	ELECTRICAL	STEAM / GAS	ELECTRICAL	STEAM / GAS	
Tension 120 V - I / 230V - I + N + T	Nº x mm2 / A	3 x 35 / 63A	3 x 1,5 / 20A	-	3 x 1,5 / 20A	-	3 x 1,5 / 20A	
Tension 230V - III + T	Nº x mm2 / A	4 x 10 / 40A	3 x 1,5 / 20A	4 x 16 / 63A	3 x 1,5 / 20A	4 x 25 / 80A	3 x 1,5 / 20A	
Tension 400V - III + N + T	Nº x mm2 / A	5 x 4 / 25A	3 x 1,5 / 20A	5 x 10 / 32A	3 x 1,5 / 20A	5 x 10 / 40A	3 x 1,5 / 20A	
Ø Gas inlet	BSP	1/2"		1/2"		1/2"		
Ø Steam inlet	BSP	3/4"		3/4"		1"		
Ø Condensed (Steam models)	BSP	3/4"		3/4"		1"		
DIMENSIONS / PACKING DIMENSIONS								
Net Width / Gross Width	in	31 / 34		31 / 34		35 / 38		
Net Depth / Gross Depth	in	33 / 37		44 / 48		49 / 53		
Net Height / Gross Height	in	67 / 73		67 / 73		71 / 76		
Height without heating battery	in	-		-		-		
Net weight / Gross weight	lb	379 / 396		412 / 440		462 / 485		
OTHERS								
Max airflow	CFM	500		500		706		
Ø Duct Size	in	8		8		8		
Sound level	dB	64		64		65		

* It may vary depending on the type of heating, filter cleanliness or extraction type.

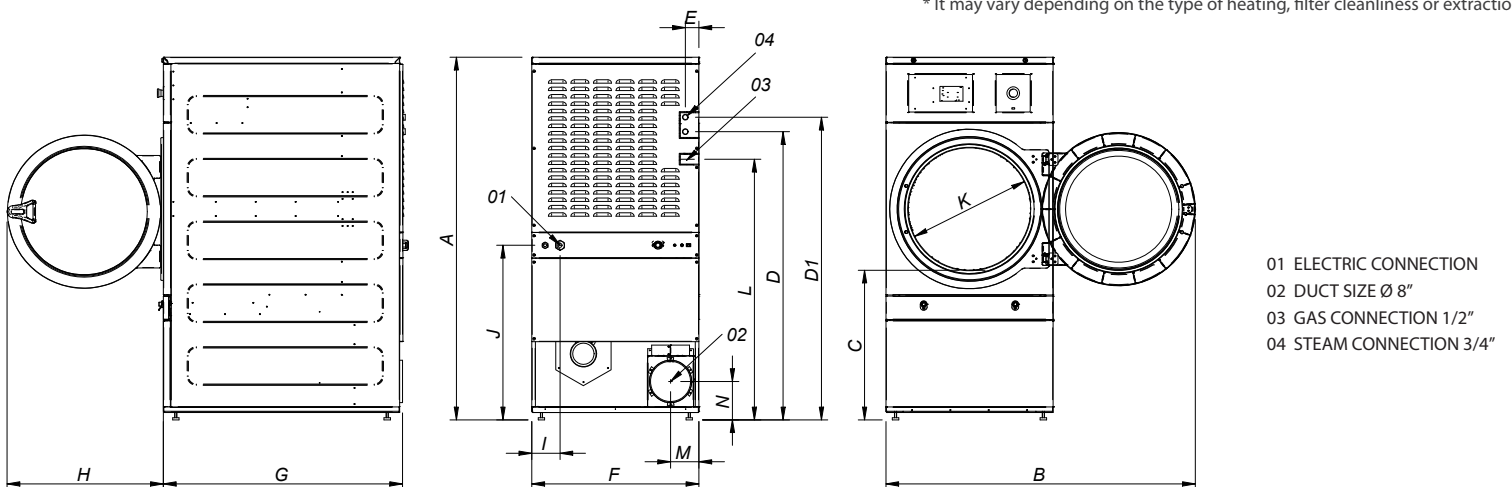

	A	B	C	D	D1	E	F	G	H	I	J	K	L	M	N
FD PLUS-25	67	57	27	54	56	3	31	34	29	3.75	33	23	48.25	5.25	7
FD PLUS-35	67	57	27	54	56	3	31	44.25	29	3.75	33	23	48.25	5.25	7
FD PLUS-50	71	61	29.25	56.25	60.25	4.50	35	49.50	29	8	34	23	53	5.25	7





TUMBLE
DRYERS

GREEN

FAGOR 
FAGOR INDUSTRIAL



FD PLUS 65-80 GREEN EVOLUTION

THE PERFECT BALANCE BETWEEN
QUALITY AND PRICE.

Mixed Flow

MP
Control

Autoreverse
DRUM

Stainless Steel
DRUM

SOFT
TOUCH

FEATURES

- Auto-reverse Drum: the drying process is more efficient; offers better uniformity, avoiding the tangling of big pieces.
- Frequency inverter: controls rotating speed and reverse drum action.
- Filter drawer with wide surface and improved airflow made of stainless steel.
- Outer casing in grey skin-plate, stainless steel look.
- Stainless Steel Drum.
- "MP Control" range: easy and intuitive electronic control offers a complete control of the process: possibility to select required drum speed, statistics control, technical menu, alarms, etc. 10 standard programs that can be modified.
- Soft Touch: the stamped drum perforations make sure the liner is gently handled, lengthening the garments lifetime.
- Total Flow: optimized mixed axial-radial flow through further openings and back-of-the-drum air reintroduction.
- iDRY: humidity sensor that offers a precise humidity control; by this system the drying cycle will automatically stop when it reaches the set level of residual humidity.
- Fire Care System.
- Green Flow System: recirculation system that reintroduces the expelled hot air inside the drum.
- Insulated Panels: complete circuit of the air-flow has been thermally insulated (panels, double door-glass, recirculation duct).
- Big loading door (opening of 180°).
- Transmission of movement by gear motor (direct drive).
- Cool Down: anti-wrinkle at the end of cycle.

Models available in electric,
gas or steam heating.

OPTIONS:

- Stainless steel body.
- Stainless steel front panel.
- Low pressure steam battery.
- Model versions in 60 Hz.
- Marine versions 440V III 50/60 Hz
No neutral or 480V III 50/60 Hz



www.fagorcommercial.com

FAGOR COMMERCIAL, INC.

13105 NW 47th Ave
Opa-locka 33054

Phone (305) 779 0170
us.marketing@onnergroupp.com



TECHNICAL DATA		UNIT.	FD PLUS- 65		FD PLUS- 80	
CAPACITY						
Capacity 1/18	lb	70		80		
Capacity 1/20	lb	60		75		
Hourly Output *	lb/h	59,3		138 / 9		
Evaporation capacity *	l/h	30,9		32,1		
DRUM						
Ø Drum	in	37.25		37.25		
Ø Door	in	31.50		31.50		
Door center height	in	41		41		
Load hole bottom height	in	64.50		64.50		
Drum length	in	30.75		36.85		
Drum volume	CðFt	19		23		
POWER						
Drum motor power	HP	0,75		0,75		
Fan motor power	HP	0,75		0,75		
Electric heating power	Kw	30		36		
Total electric power (elec.model)	Kw	31,15		37,15		
Gas heating power	BTU	139898		139898		
Total electric power (gas model)	Kw	1,15		1,15		
Steam heating power	kw	50,1		50,1		
Steam heating power (gas model)	kw	1,15		1,15		
CONNECTIONS		ELECTRICAL		STEAM / GAS		
Tension 120 V - I / 230V - I + N + T	Nº x mm2 / A	-		3 x 1,5 / 20A		
Tension 230V - III + T	Nº x mm2 / A	4 x 35 / 100A		3 x 1,5 / 20A		
Tension 400V - III + N + T	Nº x mm2 / A	5 x 16 / 63A		3 x 1,5 / 20A		
Ø Gas inlet	BSP	1/2"		1/2"		
Ø Steam inlet	BSP	1"		1"		
Ø Condensed (Steam models)	BSP	1"		1"		
DIMENSIONS / PACKING DIMENSIONS						
Net Width / Gross Width	in	38.75 / 42		38.75 / 42		
Net Depth / Gross Depth	in	41.50 / 45.50		47.60 / 51.60		
Net Height / Gross Height	in	76.60 / 82		76.60 / 82		
Height without heating battery	in	-		-		
Net weight / Gross weight	lb	507 / 573		573 / 628		
OTHERS						
Max airflow	CFM	706		706		
Ø Duct Size	in	8		8		
Sound level	dB	65		65		

* It may vary depending on the type of heating, filter cleanliness or extraction type.

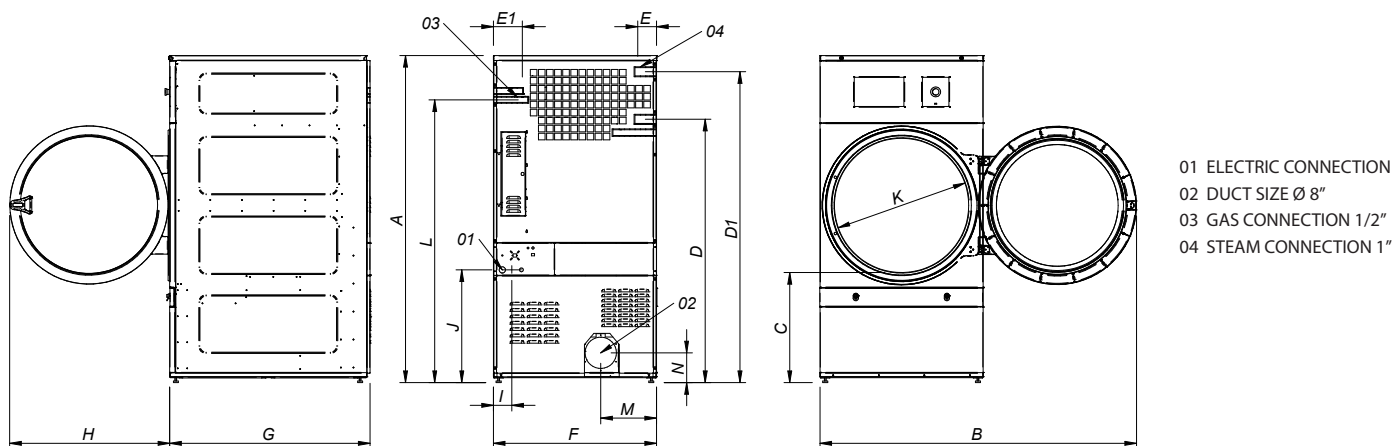

	A	B	C	D	D1	E	E1	F	G	H	I	J	K	L	M	N
FD PLUS-65	76.60	75	25	62.60	74	4.50	6.85	38.75	41.50	37.75	4.30	26.75	31.60	67.25	13.35	7
FD PLUS-80	76.60	75	25	62.60	74	4.50	6.85	38.75	47.60	37.75	4.30	26.75	31.60	67.25	13.35	7





TUMBLE
DRYERS

GREEN
EVOLUTION

FAGOR 
FAGOR INDUSTRIAL



FDM 25-35-50

THE PERFECT BALANCE BETWEEN
QUALITY AND PRICE.

Mixed
Flow

MP
Control

Autoreverse
DRUM

Stainless
Steel DRUM

SOFT
TOUCH

FEATURES

- Auto-reverse Drum: the drying process is more efficient; offers better uniformity, avoiding the tangling of big pieces.
- Frequency inverter: controls rotating speed and reverse drum action.
- Filter drawer with wide surface and improved airflow made of stainless steel.
- Outer casing in galvanized steel.
- Galvanized Steel Drum.
- "M Control" range: easy to use analogic control with time and temperature selection.
- Radial airflow circuit.
- Big loading door (opening of 180°).
- Transmission of movement by gear motor (direct drive).
- Cool Down: Anti-wrinkle at the end of cycle.

Models available in electric or gas heating.

OPTIONS:

- Version in 60 Hz.
- Marine versions 440V III 60 Hz No neutral or 480V III 60 Hz No



www.fagorcommercial.com

FAGOR COMMERCIAL, INC.

13105 NW 47th Ave
Opa-locka 33054

Phone (305) 779 0170
us.marketing@onnergroupp.com



TECHNICAL DATA	UNIT.	FDM- 25	FDM- 35	FDM- 50			
CAPACITY							
Capacity 1/18	lb	26	40	60			
Capacity 1/20	lb	25	35	50			
Hourly Output *	lb/h	62/ 6	68 / 9	88 / 6			
Evaporation Capacity *	l/h	14,5	16,3	20,4			
DRUM							
Ø Drum	in	29.50	29.50	33			
Ø Door	in	22.50	22.50	22.50			
Door Center Height	in	38.50	38.50	40.50			
Door Bottom Height	in	27	27	29.25			
Drum Depth	in	18.70	29.30	31.50			
Drum Volume	CuFt	7	12	17			
POWER							
Drum motor power	HP	1	1	1			
Fan motor power	HP	0.33	0.33	0,75			
Electric heating power	kw	16	24	32			
Total electric power (elec.model)	kw	16.99	25.03	33.48			
Gas heating power	BTU	93,834	93,834	141,843			
Total electric power (gas model)	kw	0.89	0.89	1.3			
Steam heating power	kw	40	40	66			
Steam heating power (gas model)	kw	0.89	0,89	1.3			
CONNECTIONS		ELECTRICAL	STEAM / GAS	ELECTRICAL	STEAM / GAS	ELECTRICAL	STEAM / GAS
Tension 120 V - I / 230V - I + N + T	Nº x mm2 / A	3 x 35 / 63A	3 x 1,5 / 20A	-	3 x 1,5 / 20A	-	3 x 1,5 / 20A
Tension 230V - III + T	Nº x mm2 / A	4 x 10 / 40A	3 x 1,5 / 20A	4 x 16 / 63A	3 x 1,5 / 20A	4 x 25 / 80A	3 x 1,5 / 20A
Tension 400V - III + N + T	Nº x mm2 / A	5 x 4 / 25A	3 x 1,5 / 20A	5 x 10 / 32A	3 x 1,5 / 20A	5 x 10 / 40A	3 x 1,5 / 20A
Ø Gas inlet	BSP	1/2"		1/2"		1/2"	
Ø Steam inlet	BSP	3/4"		3/4"		1"	
Ø Condensed (Steam models)	BSP	3/4"		3/4"		1"	
DIMENSIONS / PACKING DIMENSIONS							
Net Width / Gross Width	in	31 / 34		31 / 34		35 / 38	
Net Depth / Gross Depth	in	33 / 37		44 / 48		49 / 53	
Net Height / Gross Height	in	67 / 73		67 / 73		71 / 76	
Height without heating battery	in	-		-		-	
Net weight / Gross weight	lb	379 / 396		412 / 440		462 / 485	
OTHERS							
Max airflow	CFM	500		500		706	
Ø Duct Size	in	8		8		8	
Sound level	dB	64		64		65	

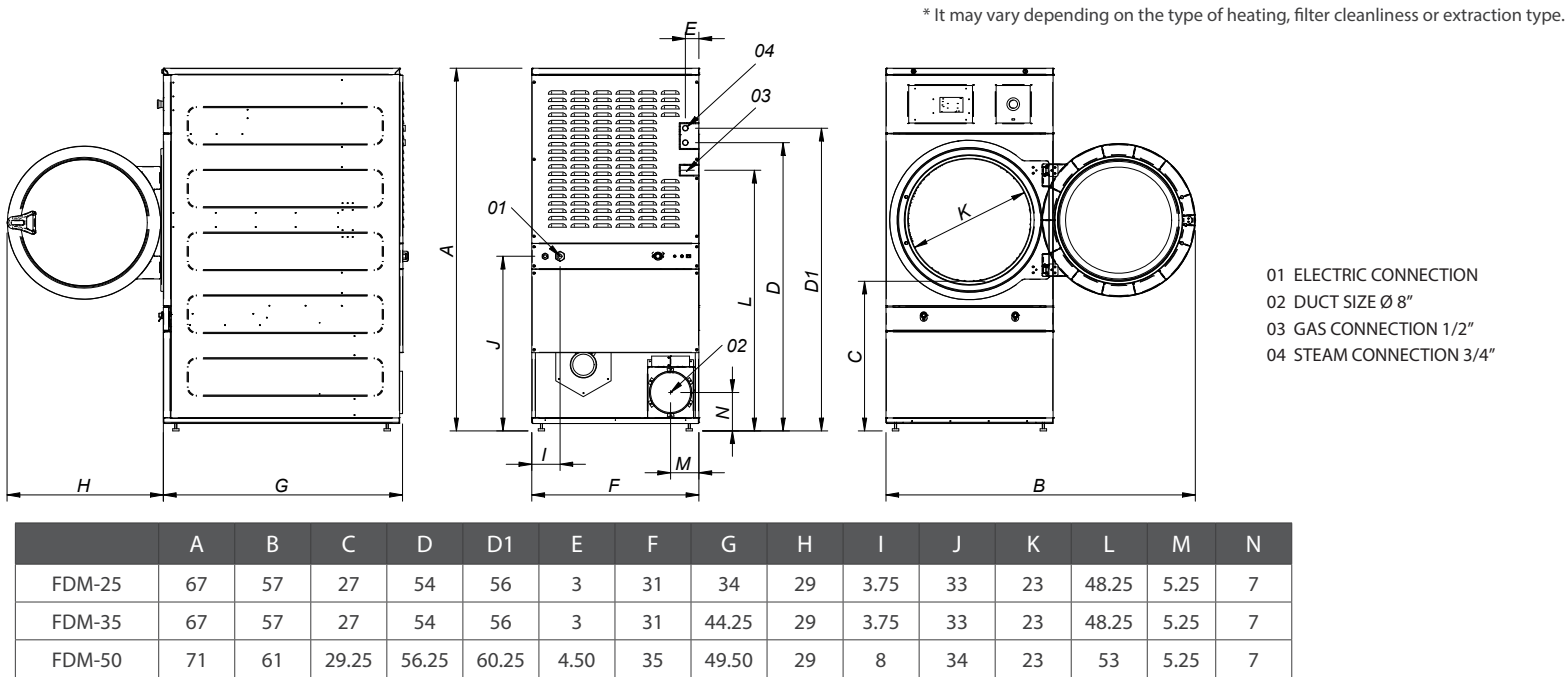



TUMBLE
DRYERS

GREEN
EVOLUTION

FAGOR 
FAGOR INDUSTRIAL



FDM - 65 - 80

THE PERFECT BALANCE BETWEEN
QUALITY AND PRICE.

Mixed
Flow

MP
Control

Autoreverse
DRUM

Stainless
Steel DRUM

SOFT
TOUCH

FEATURES

- Auto-reverse Drum: the drying process is more efficient; offers better uniformity, avoiding the tangling of big pieces.
- Frequency inverter: controls rotating speed and reverse drum action.
- Filter drawer with wide surface and improved airflow made of stainless steel.
- Outer casing in galvanized steel.
- Galvanized Steel Drum.
- "M Control" range: easy to use analogic control with time and temperature selection.
- Radial airflow circuit.
- Big loading door (opening of 180°).
- Transmission of movement by gear motor (direct drive).
- Cool Down: Anti-wrinkle at the end of cycle.

Models available in electric or gas heating.

OPTIONS:

- Version in 60 Hz.
- Marine versions 440V III 60 Hz No neutral or 480V III 60 Hz No



www.fagorcommercial.com

FAGOR COMMERCIAL, INC.

13105 NW 47th Ave
Opa-locka 33054

Phone (305) 779 0170
us.marketing@onnergroupp.com



TECHNICAL DATA		UNIT.	FDM - 65		FDM- 80	
CAPACITY						
Capacity 1/18	lb	70		80		
Capacity 1/20	lb	60		75		
Hourly Output *	lb/h	59,3		138 / 9		
Evaporation capacity *	l/h	30,9		32,1		
DRUM						
Ø Drum	in	37.25		37.25		
Ø Door	in	31.50		31.50		
Door center height	in	41		41		
Load hole bottom height	in	64.50		64.50		
Drum length	in	30.75		36.85		
Drum volume	CðFt	19		23		
POWER						
Drum motor power	HP	0,75		0,75		
Fan motor power	HP	0,75		0,75		
Electric heating power	Kw	30		36		
Total electric power (elec.model)	Kw	31,15		37,15		
Gas heating power	BTU	139898		139898		
Total electric power (gas model)	Kw	1,15		1,15		
Steam heating power	kw	50,1		50,1		
Steam heating power (gas model)	kw	1,15		1,15		
CONNECTIONS		ELECTRICAL		STEAM / GAS		
Tension 120 V - I / 230V - I + N + T	Nº x mm2 / A	-		3 x 1,5 / 20A		
Tension 230V - III + T	Nº x mm2 / A	4 x 35 / 100A		3 x 1,5 / 20A		
Tension 400V - III + N + T	Nº x mm2 / A	5 x 16 / 63A		3 x 1,5 / 20A		
Ø Gas inlet	BSP	1/2"		1/2"		
Ø Steam inlet	BSP	1"		1"		
Ø Condensed (Steam models)	BSP	1"		1"		
DIMENSIONS / PACKING DIMENSIONS						
Net Width / Gross Width	in	38.75 / 42		38.75 / 42		
Net Depth / Gross Depth	in	41.50 / 45.50		47.60 / 51.60		
Net Height / Gross Height	in	76.60 / 82		76.60 / 82		
Height without heating battery	in	-		-		
Net weight / Gross weight	lb	507 / 573		573 / 628		
OTHERS						
Max airflow	CFM	706		706		
Ø Duct Size	in	8		8		
Sound level	dB	65		65		

* It may vary depending on the type of heating, filter cleanliness or extraction type.

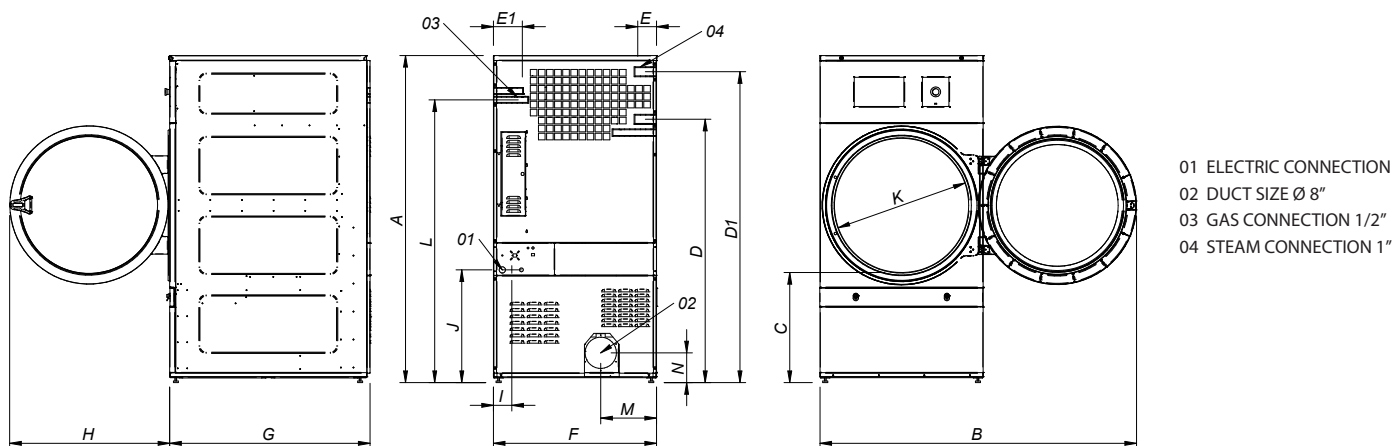

	A	B	C	D	D1	E	E1	F	G	H	I	J	K	L	M	N
FDM-65	76.60	75	25	62.60	74	4.50	6.85	38.75	41.50	37.75	4.30	26.75	31.60	67.25	13.35	7
FDM-80	76.60	75	25	62.60	74	4.50	6.85	38.75	47.60	37.75	4.30	26.75	31.60	67.25	13.35	7





TUMBLE
DRYERS

GREEN
EVOLUTION

FAGOR 
FAGOR INDUSTRIAL



FED-25-35-50

THE PERFECT BALANCE BETWEEN
QUALITY AND PRICE.

Mixed
Flow

MP
Control

Autoreverse
DRUM

Stainless
Steel DRUM

SOFT
TOUCH

FEATURES

- Auto-reverse Drum: the drying process is more efficient; offers better uniformity, avoiding the tangling of big pieces.
- Frequency inverter: controls rotating speed and reverse drum action.
- Filter drawer with wide surface and improved airflow made of stainless steel.
- Outer casing in galvanized steel.
- Galvanized Steel Drum.
- "M Control" range: easy to use analogic control with time and temperature selection.
- Radial airflow circuit.
- Big loading door (opening of 180°).
- Transmission of movement by gear motor (direct drive).
- Cool Down: Anti-wrinkle at the end of cycle.

Models available in electric or gas heating.

OPTIONS:

- Version in 60 Hz.
- Marine versions 440V III 60 Hz No neutral or 480V III 60 Hz No



www.fagorcommercial.com

FAGOR COMMERCIAL, INC.

13105 NW 47th Ave
Opa-locka 33054

Phone (305) 779 0170
us.marketing@onnergroupp.com



TECHNICAL DATA		UNIT.	FED- 25		FED 35		FED- 50	
CAPACITY								
Capacity 1/18	lb	26		40		60		
Capacity 1/20	lb	25		35		50		
Hourly Output *	lb/h	62/ 6		68 / 9		88 / 6		
Evaporation Capacity *	l/h	14,5		16,3		20,4		
DRUM								
Ø Drum	in	29.50		29.50		33		
Ø Door	in	22.50		22.50		22.50		
Door Center Height	in	38.50		38.50		40.50		
Door Bottom Height	in	27		27		29.25		
Drum Depth	in	18.70		29.30		31.50		
Drum Volume	CuFt	7		12		17		
POWER								
Drum motor power	HP	1		1		1		
Fan motor power	HP	0.33		0.33		0,75		
Electric heating power	kw	16		24		32		
Total electric power (elec.model)	kw	16.99		25.03		33.48		
Gas heating power	BTU	93,834		93,834		141,843		
Total electric power (gas model)	kw	0.89		0.89		1.3		
Steam heating power	kw	40		40		66		
Steam heating power (gas model)	kw	0.89		0,89		1.3		
CONNECTIONS		ELECTRICAL	STEAM / GAS	ELECTRICAL	STEAM / GAS	ELECTRICAL	STEAM / GAS	
Tension 120 V - I / 230V - I + N + T	Nº x mm2 / A	3 x 35 / 63A	3 x 1,5 / 20A	-	3 x 1,5 / 20A	-	3 x 1,5 / 20A	
Tension 230V - III + T	Nº x mm2 / A	4 x 10 / 40A	3 x 1,5 / 20A	4 x 16 / 63A	3 x 1,5 / 20A	4 x 25 / 80A	3 x 1,5 / 20A	
Tension 400V - III + N + T	Nº x mm2 / A	5 x 4 / 25A	3 x 1,5 / 20A	5 x 10 / 32A	3 x 1,5 / 20A	5 x 10 / 40A	3 x 1,5 / 20A	
Ø Gas inlet	BSP	1/2"		1/2"		1/2"		
Ø Steam inlet	BSP	3/4"		3/4"		1"		
Ø Condensed (Steam models)	BSP	3/4"		3/4"		1"		
DIMENSIONS / PACKING DIMENSIONS								
Net Width / Gross Width	in	31 / 34		31 / 34		35 / 38		
Net Depth / Gross Depth	in	33 / 37		44 / 48		49 / 53		
Net Height / Gross Height	in	67 / 73		67 / 73		71 / 76		
Height without heating battery	in	-		-		-		
Net weight / Gross weight	lb	379 / 396		412 / 440		462 / 485		
OTHERS								
Max airflow	CFM	500		500		706		
Ø Duct Size	in	8		8		8		
Sound level	dB	64		64		65		

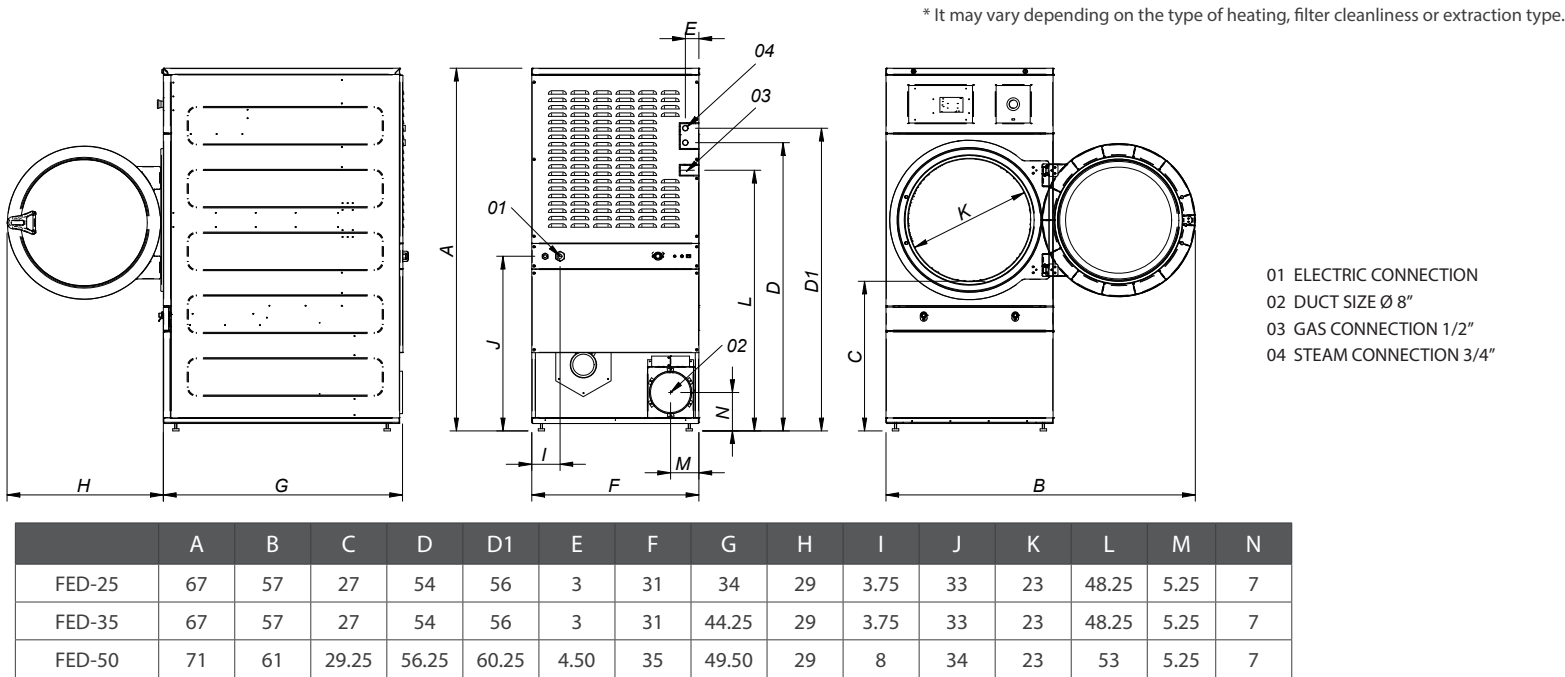



TUMBLE
DRYERS

GREEN
EVOLUTION

FAGOR 
FAGOR INDUSTRIAL



FED- 65 -80

THE PERFECT BALANCE BETWEEN
QUALITY AND PRICE.

Mixed
Flow

MP
Control

Autoreverse
DRUM

Stainless
Steel DRUM

SOFT
TOUCH

FEATURES

- Auto-reverse Drum: the drying process is more efficient; offers better uniformity, avoiding the tangling of big pieces.
- Frequency inverter: controls rotating speed and reverse drum action.
- Filter drawer with wide surface and improved airflow made of stainless steel.
- Outer casing in galvanized steel.
- Galvanized Steel Drum.
- "M Control" range: easy to use analogic control with time and temperature selection.
- Radial airflow circuit.
- Big loading door (opening of 180°).
- Transmission of movement by gear motor (direct drive).
- Cool Down: Anti-wrinkle at the end of cycle.

Models available in electric or gas heating.

OPTIONS:

- Version in 60 Hz.
- Marine versions 440V III 60 Hz No neutral or 480V III 60 Hz No



www.fagorcommercial.com

FAGOR COMMERCIAL, INC.

13105 NW 47th Ave
Opa-locka 33054

Phone (305) 779 0170
us.marketing@onnergroupp.com



TECHNICAL DATA		UNIT.	FED- 65		FED- 80	
CAPACITY						
Capacity 1/18	lb	70		80		
Capacity 1/20	lb	60		75		
Hourly Output*	lb/h	59,3		138 / 9		
Evaporation capacity*	l/h	30,9		32,1		
DRUM						
Ø Drum	in	37.25		37.25		
Ø Door	in	31.50		31.50		
Door center height	in	41		41		
Load hole bottom height	in	64.50		64.50		
Drum length	in	30.75		36.85		
Drum volume	CuFt	19		23		
POWER						
Drum motor power	HP	0,75		0,75		
Fan motor power	HP	0,75		0,75		
Electric heating power	Kw	30		36		
Total electric power (elec.model)	Kw	31,15		37,15		
Gas heating power	BTU	139898		139898		
Total electric power (gas model)	Kw	1,15		1,15		
Steam heating power	kw	50,1		50,1		
Steam heating power (gas model)	kw	1,15		1,15		
CONNECTIONS		ELECTRICAL	STEAM / GAS	ELECTRICAL	STEAM / GAS	
Tension 120 V - I / 230V - I + N + T	Nº x mm2 / A	-	3 x 1,5 / 20A	-	3 x 1,5 / 20A	
Tension 230V - III + T	Nº x mm2 / A	4 x 35 / 100A	3 x 1,5 / 20A	4 x 50 / 125A	3 x 1,5 / 20A	
Tension 400V - III + N + T	Nº x mm2 / A	5 x 16 / 63A	3 x 1,5 / 20A	5 x 16 / 63A	3 x 1,5 / 20A	
Ø Gas inlet	BSP	1/2"		1/2"		
Ø Steam inlet	BSP	1"		1"		
Ø Condensed (Steam models)	BSP	1"		1"		
DIMENSIONS / PACKING DIMENSIONS						
Net Width / Gross Width	in	38.75 / 42		38.75 / 42		
Net Depth / Gross Depth	in	41.50 / 45.50		47.60 / 51.60		
Net Height / Gross Height	in	76.60 / 82		76.60 / 82		
Height without heating battery	in	-		-		
Net weight / Gross weight	lb	507 / 573		573 / 628		
OTHERS						
Max airflow	CFM	706		706		
Ø Duct Size	in	8		8		
Sound level	dB	65		65		

