



Catalogue

Chapter

Model

LMED-16 TP2 E 230/400/440V 3N/3 50/60Hz

18002262

11/02/2020

SANITARY BARRIER WASHER EXTRACTOR, LMED-16 TP2 E

- New TP2 processor with 4.3" touch screen on the dirty side (optional on the clean side).
- 2 water inlets.
- External steel casing with grey coating (skinplate), stainless steel, easy to clean finish.
- Heating versions: electric and steam.
- Double heating version, selectable electric and steam.
- 29 programs pre-set from factory.
- Traceability as standard.
- 8 signals for automatic liquid dosing, programmable in time and delay.
- Optimum load. Intelligent weighing system.
- Possibility of configuring three levels of savings. 6 extra signals available optionally.
- Designed for water recovery tanks. Low water consumption.
- 1-compartment horizontal spin drum.
- Loading and unloading doors. Door locks with safety opening
- Electrical part to the left, mechanical to the right, connections at the top.
- Central drain.
- Technical menu. Statistics, alarms, autotest, data recovery for technicians and maintenance.
- Motor with variable-frequency drive incorporated.
- Prepared for Wet cleaning
- Electric heating version
- 1 compartment with useful drum opening dimension of 400x315 mm

OPTIONS:

- Weight System (WS)
- Side Drain Valve (SDV)
- Detergent Box (DBX)
- Electric Battery Motor Brake (UPS)
- Motor Brake (BR)
- 6 extra dosage signals (XD)
- Second screen (2SC)
- 2nd Drain Valve (DD)
- Titration Valve (TV)
- Stainless Steel Case (SSC)
- Wooden Maritime Packaging (WM)
- Printer Kit (PR)
- Low Pressure Steam (LPS)
- Different voltage options.

"
"

DIMENSIONS

X Width	984 mm	X Gross width	1072 mm
Y Depth	914 mm	Y Gross depth	1102 mm
Z Height	1398 mm	Z Gross height	1530 mm
Net Weight	438,0 kg	Gross Weight	459,0 kg
Net volume	1,260 m3	Gross volume	1,807 m3

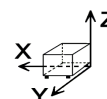

ELECTRICITY TECHNICAL SPECIFICATIONS

Engine power	2,20 kW
Electric power	14,200 kW
Amperage (A)	30/21A
Heating power	12,00 kW
Voltage	230/400/440V - 3N/3
Electric frequency	50/60Hz

WATER TECHNICAL SPECIFICATIONS

Pressure	H2O: 200-400kPa(2-4bar)
Water max consumption	144,00 L/h

CONNECTIONS TECHNICAL SPECIFICATIONS

230 V three-phase wiring	4 X 10 / 32A
Three-phase +N 400V wiring	5 X 6 / 21A
Water inlet diameter	3/4"
Drain 1 diameter	3"
Drainage capacity	160 l/min

OTHERS

Load capacity 1/9	18,00 kg
Load capacity 1/10	16,00 kg
Drum volume	158 L
Drum diameter	633 mm
Drum depth	500 mm
Drum compartments	1
Wash speed	45,0 r.p.m.
Max revolutions	1000 r.p.m.
G Factor	350
Frequency of dynamic load (Hz)	16,70
Noise level	65,00 dB



Catalogue

Chapter

Model

LMED-16 TP2 E 230/400/440V 3N/3 50/60Hz

18002262

11/02/2020

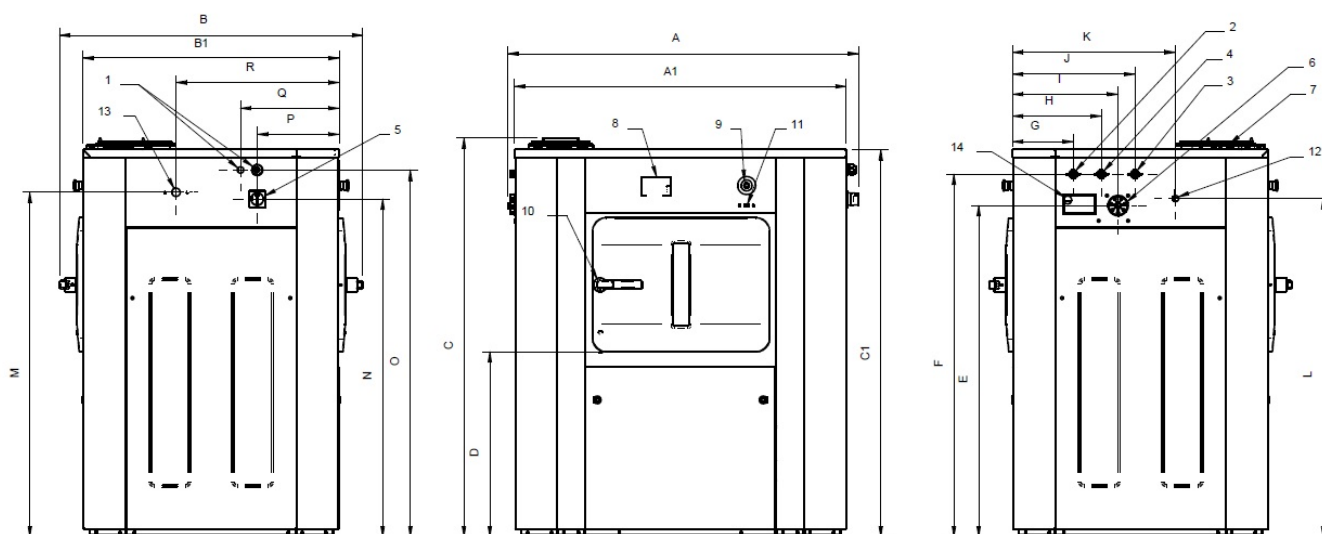

- 01. CONEXIÓN ELÉCTRICA
- 02. AGUA CALIENTE
- 03. AGUA FRÍA
- 04. AGUA DESCALCIFICADA
- 05. INTERRUPTOR GENERAL
- 06. ENTRADA PRODUCTOS LÍQUIDOS
- 07. JABONERA (OPCIÓN)
- 08. PANEL DE CONTROL
- 09. PARADA DE EMERGENCIA
- 10. APERTURA DE PUERTA
- 11. PUERTO USB
- 12. CONEXIÓN BOMBA DOSIFICADORA
- 13. ENTRADA VAPOR
- 14. SALIDA DE VAHOS

- 01. ELECTRICAL CONNEXION
- 02. HOT WATER
- 03. COLD WATER
- 04. SOFT WATER
- 05. MAIN SWITCH
- 06. LIQUID PRODUCTS INLET
- 07. DETERGENT BOX (OPTION)
- 08. CONTROL PANEL
- 09. EMERGENCY STOP
- 10. DOOR OPENING
- 11. USB PORT
- 12. DOSING PUMPS CONNEXION
- 13. STEAM INLET
- 14. EXHAUST

- 01. CONNEXION ELECTRIQUE
- 02. EAU CHAUDE
- 03. EAU FROIDE
- 04. EAU ADOUCIE
- 05. INTERRUPTEUR GENERAL
- 06. ENTREE PRODUITS LIQUIDES
- 07. BAC A PRODUITS (OPTION)
- 08. PANNEAU DE COMMANDE
- 09. ARRÊT D'URGENCE
- 10. OUVERTURE PORTE
- 11. PORT USB
- 12. CONNEXION POMPES DOSEUSES
- 13. ENTREE VAPEUR
- 14. EVENT

	A	B	C	A1	B1	C1	D	E	F	G	H	I	J	K	L	M	N	O	P	Q	R
LMED-16	1.054	1.082	1.426	984	914	1.385	661	1.184	1.296	217	317	377	437	582	1.209	1.231	1.207	1.311	292	352	582
LMED-22	1.254	1.082	1.426	1.184	914	1.385	661	1.184	1.296	217	317	377	437	582	1.209	1.231	1.207	1.311	292	352	582



Catalogue

Chapter

Model

LMED-16 TP2 E 230...400V 3/3N 50/60Hz

19066871

11/02/2020

SANITARY BARRIER WASHER EXTRACTOR, LMED-16 TP2 E

- New TP2 processor with 4.3" touch screen on the dirty side (optional on the clean side).
- 2 water inlets.
- External steel casing with grey coating (skinplate), stainless steel, easy to clean finish.
- Heating versions: electric and steam.
- Double heating version, selectable electric and steam.
- 29 programs pre-set from factory.
- Traceability as standard.
- 8 signals for automatic liquid dosing, programmable in time and delay.
- Optimum load. Intelligent weighing system.
- Possibility of configuring three levels of savings. 6 extra signals available optionally.
- Designed for water recovery tanks. Low water consumption.
- 1-compartment horizontal spin drum.
- Loading and unloading doors. Door locks with safety opening
- Electrical part to the left, mechanical to the right, connections at the top.
- Central drain.
- Technical menu. Statistics, alarms, autotest, data recovery for technicians and maintenance.
- Motor with variable-frequency drive incorporated.
- Prepared for Wet cleaning
- Electric heating version
- 1 compartment with useful drum opening dimension of 400x315 mm

OPTIONS:

- Weight System (WS)
- Side Drain Valve (SDV)
- Detergent Box (DBX)
- Electric Battery Motor Brake (UPS)
- Motor Brake (BR)
- 6 extra dosage signals (XD)
- Second screen (2SC)
- 2nd Drain Valve (DD)
- Titration Valve (TV)
- Stainless Steel Case (SSC)
- Wooden Maritime Packaging (WM)
- Printer Kit (PR)
- Low Pressure Steam (LPS)
- Different voltage options.

"
"

DIMENSIONS

X Width	984 mm	X Gross width	1072 mm
Y Depth	914 mm	Y Gross depth	1102 mm
Z Height	1398 mm	Z Gross height	1530 mm
Net Weight	438,0 kg	Gross Weight	459,0 kg
Net volume	1,260 m3	Gross volume	1,807 m3

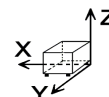

ELECTRICITY TECHNICAL SPECIFICATIONS

Engine power	2,20 kW
Electric power	14,200 kW
Amperage (A)	30/21A
Heating power	12,00 kW
Voltage	230/400V - 3/3N
Electric frequency	50/60Hz

WATER TECHNICAL SPECIFICATIONS

Pressure	H2O: 200-400kPa(2-4bar)
Water max consumption	144,00 L/h

CONNECTIONS TECHNICAL SPECIFICATIONS

230 V three-phase wiring	4 X 10 / 32A
Three-phase +N 400V wiring	5 X 6 / 21A
Water inlet diameter	3/4"
Drain 1 diameter	3"
Drainage capacity	160 l/min

OTHERS

Load capacity 1/9	18,00 kg
Load capacity 1/10	16,00 kg
Drum volume	158 L
Drum diameter	633 mm
Drum depth	500 mm
Drum compartments	1
Wash speed	45,0 r.p.m.
Max revolutions	1000 r.p.m.
G Factor	350
Frequency of dynamic load (Hz)	16,70
Noise level	65,00 dB



Catalogue

Chapter

Model

LMED-16 TP2 E 230...400V 3/3N 50/60Hz

19066871

11/02/2020

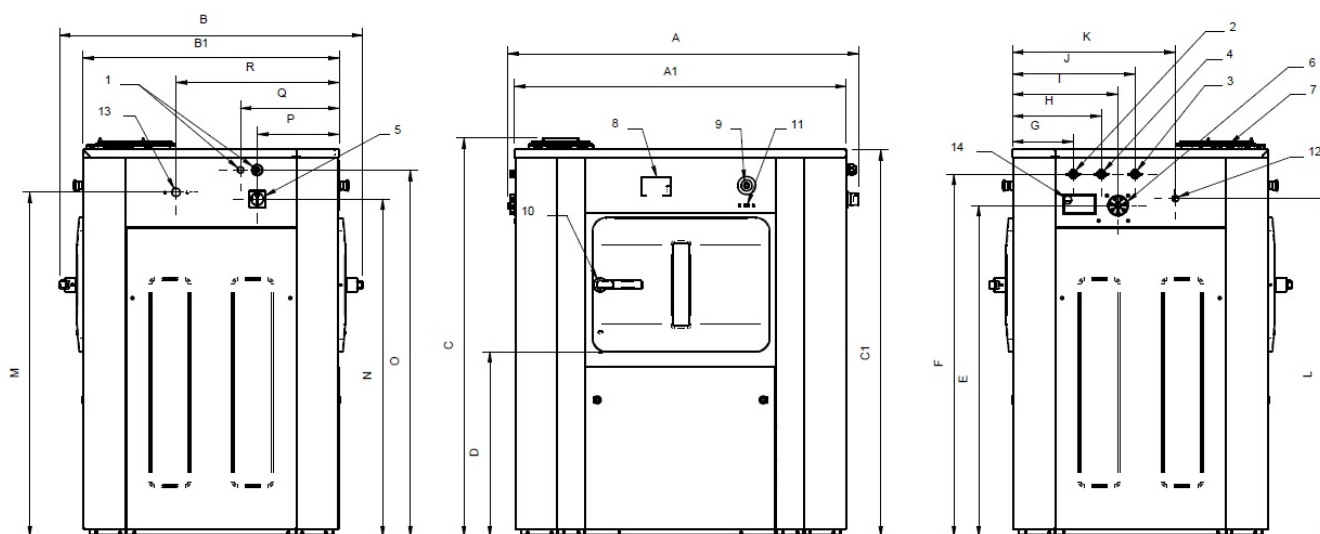

- 01. CONEXIÓN ELÉCTRICA
- 02. AGUA CALIENTE
- 03. AGUA FRÍA
- 04. AGUA DESCALCIFICADA
- 05. INTERRUPTOR GENERAL
- 06. ENTRADA PRODUCTOS LÍQUIDOS
- 07. JABONERA (OPCIÓN)
- 08. PANEL DE CONTROL
- 09. PARADA DE EMERGENCIA
- 10. APERTURA DE PUERTA
- 11. PUERTO USB
- 12. CONEXIÓN BOMBA DOSIFICADORA
- 13. ENTRADA VAPOR
- 14. SALIDA DE VAHOS

- 01. ELECTRICAL CONNEXION
- 02. HOT WATER
- 03. COLD WATER
- 04. SOFT WATER
- 05. MAIN SWITCH
- 06. LIQUID PRODUCTS INLET
- 07. DETERGENT BOX (OPTION)
- 08. CONTROL PANEL
- 09. EMERGENCY STOP
- 10. DOOR OPENING
- 11. USB PORT
- 12. DOSING PUMPS CONNEXION
- 13. STEAM INLET
- 14. EXHAUST

- 01. CONNEXION ELECTRIQUE
- 02. EAU CHAUDE
- 03. EAU FROIDE
- 04. EAU ADOUCIE
- 05. INTERRUPTEUR GENERAL
- 06. ENTREE PRODUITS LIQUIDES
- 07. BAC A PRODUITS (OPTION)
- 08. PANNEAU DE COMMANDE
- 09. ARRET D'URGENCE
- 10. OUVERTURE PORTE
- 11. PORT USB
- 12. CONNEXION POMPES DOSEUSES
- 13. ENTREE VAPEUR
- 14. EVENT

	A	B	C	A1	B1	C1	D	E	F	G	H	I	J	K	L	M	N	O	P	Q	R
LMED-16	1.054	1.082	1.426	984	914	1.385	661	1.184	1.296	217	317	377	437	582	1.209	1.231	1.207	1.311	292	352	582
LMED-22	1.254	1.082	1.426	1.184	914	1.385	661	1.184	1.296	217	317	377	437	582	1.209	1.231	1.207	1.311	292	352	582



Catalogue

Chapter

Model

LMED-16 TP2 ES 230/400/440V 3N/3 50/60Hz

18002264

10/02/2020

SANITARY BARRIER WASHER EXTRACTOR, LMED-16 TP2 ES

- New TP2 processor with 4.3" touch screen on the dirty side (optional on the clean side).
- 2 water inlets.
- External steel casing with grey coating (skinplate), stainless steel, easy to clean finish.
- Heating versions: electric and steam.
- Double heating version, selectable electric and steam.
- 29 programs pre-set from factory.
- Traceability as standard.
- 8 signals for automatic liquid dosing, programmable in time and delay.
- Optimum load. Intelligent weighing system.
- Possibility of configuring three levels of savings. 6 extra signals available optionally.
- Designed for water recovery tanks. Low water consumption.
- 1-compartment horizontal spin drum.
- Loading and unloading doors. Door locks with safety opening
- Electrical part to the left, mechanical to the right, connections at the top.
- Central drain.
- Technical menu. Statistics, alarms, autotest, data recovery for technicians and maintenance.
- Motor with variable-frequency drive incorporated.
- Prepared for Wet cleaning
- Double heating version, selectionable between steam or electric
- 1 compartment with useful drum opening dimension of 400x315 mm

OPTIONS:

- Weight System (WS)
- Side Drain Valve (SDV)
- Detergent Box (DBX)
- Electric Battery Motor Brake (UPS)
- Motor Brake (BR)
- 6 extra dosage signals (XD)
- Second screen (2SC)
- 2nd Drain Valve (DD)
- Titration Valve (TV)
- Stainless Steel Case (SSC)
- Wooden Maritime Packaging (WM)
- Printer Kit (PR)
- Low Pressure Steam (LPS)
- Different voltage options.

"
"

DIMENSIONS

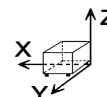

X Width	984 mm	X Gross width	1072 mm
Y Depth	914 mm	Y Gross depth	1102 mm
Z Height	1398 mm	Z Gross height	1530 mm
Net Weight	438,0 kg	Gross Weight	459,0 kg
Net volume	1,260 m3	Gross volume	1,807 m3

ELECTRICITY TECHNICAL SPECIFICATIONS

Engine power	2,20 kW
Electric power	14,200 kW
Amperage (A)	30/21A
Heating power	12,00 kW
Voltage	230/400/440V - 3N/3
Electric frequency	50/60Hz

STEAM TECHNICAL SPECIFICATIONS

Steam consumption	1,24 kg/h
Steam pressure	6,00 - 10,00 bar

WATER TECHNICAL SPECIFICATIONS

Pressure	H2O: 200-400kPa(2-4bar)
Water max consumption	144,00 L/h

CONNECTIONS TECHNICAL SPECIFICATIONS

230 V three-phase wiring	4 X 10 / 30A
Three-phase +N 400V wiring	5 X 6 / 21A
Steam entrance diameter	3/4"
Water inlet diameter	3/4"
Drain 1 diameter	3"
Drainage capacity	160 l/min

OTHERS

Load capacity 1/9	18,00 kg
Load capacity 1/10	16,00 kg
Drum volume	158 L
Drum diameter	633 mm
Drum depth	500 mm
Drum compartments	1
Wash speed	45,0 r.p.m.
Max revolutions	1000 r.p.m.
G Factor	350
Frequency of dynamic load (Hz)	16,70



Catalogue

Chapter

Model
LMED-16 TP2 ES 230/400/440V 3N/3 50/60Hz

18002264

10/02/2020

Noise level

68,00 dB

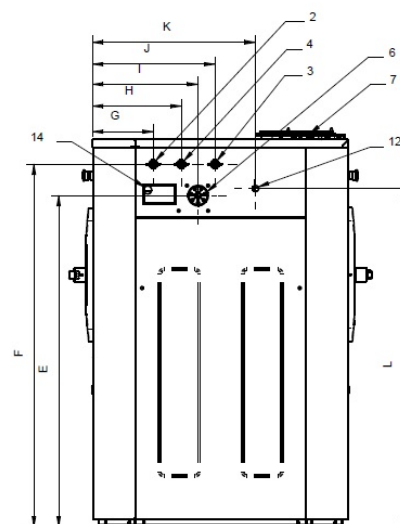
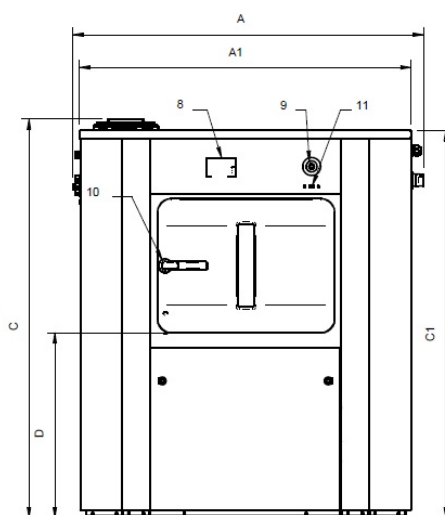
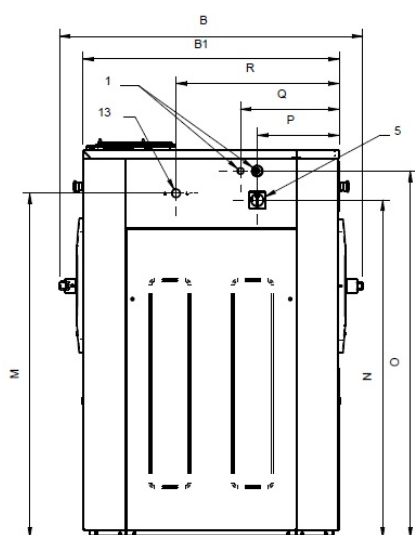

- 01. CONEXIÓN ELÉCTRICA
- 02. AGUA CALIENTE
- 03. AGUA FRÍA
- 04. AGUA DESCALCIFICADA
- 05. INTERRUPTOR GENERAL
- 06. ENTRADA PRODUCTOS LÍQUIDOS
- 07. JABONERA (OPCIÓN)
- 08. PANEL DE CONTROL
- 09. PARADA DE EMERGENCIA
- 10. APERTURA DE PUERTA
- 11. PUERTO USB
- 12. CONEXIÓN BOMBA DOSIFICADORA
- 13. ENTRADA VAPORES
- 14. SALIDA DE VAHOS

- 01. ELECTRICAL CONNEXION
- 02. HOT WATER
- 03. COLD WATER
- 04. SOFT WATER
- 05. MAIN SWITCH
- 06. LIQUID PRODUCTS INLET
- 07. DETERGENT BOX (OPTION)
- 08. CONTROL PANEL
- 09. EMERGENCY STOP
- 10. DOOR OPENING
- 11. USB PORT
- 12. DOSING PUMPS CONNEXION
- 13. STEAM INLET
- 14. EXHAUST

- 01. CONNEXION ELECTRIQUE
- 02. EAU CHAUDE
- 03. EAU FROIDE
- 04. EAU ADOUCIE
- 05. INTERRUPTEUR GENERAL
- 06. ENTREE PRODUITS LIQUIDES
- 07. BAC A PRODUITS (OPTION)
- 08. PANNEAU DE COMMANDE
- 09. ARRET D'URGENCE
- 10. OUVERTURE PORTE
- 11. PORT USB
- 12. CONNEXION POMPES DOSEUSES
- 13. ENTREE VAPEUR
- 14. EVENT

	A	B	C	A1	B1	C1	D	E	F	G	H	I	J	K	L	M	N	O	P	Q	R
LMED-16	1.054	1.082	1.426	984	914	1.385	661	1.184	1.296	217	317	377	437	582	1.209	1.231	1.207	1.311	292	352	582
LMED-22	1.254	1.082	1.426	1.184	914	1.385	661	1.184	1.296	217	317	377	437	582	1.209	1.231	1.207	1.311	292	352	582



Catalogue

Chapter

Model

LMED-16 TP2 ES 230...400V 3/3N 50/60Hz

19066873

10/02/2020

SANITARY BARRIER WASHER EXTRACTOR, LMED-16 TP2 ES

- New TP2 processor with 4.3" touch screen on the dirty side (optional on the clean side).
- 2 water inlets.
- External steel casing with grey coating (skinplate), stainless steel, easy to clean finish.
- Heating versions: electric and steam.
- Double heating version, selectable electric and steam.
- 29 programs pre-set from factory.
- Traceability as standard.
- 8 signals for automatic liquid dosing, programmable in time and delay.
- Optimum load. Intelligent weighing system.
- Possibility of configuring three levels of savings. 6 extra signals available optionally.
- Designed for water recovery tanks. Low water consumption.
- 1-compartment horizontal spin drum.
- Loading and unloading doors. Door locks with safety opening
- Electrical part to the left, mechanical to the right, connections at the top.
- Central drain.
- Technical menu. Statistics, alarms, autotest, data recovery for technicians and maintenance.
- Motor with variable-frequency drive incorporated.
- Prepared for Wet cleaning
- Double heating version, selectionable between steam or electric
- 1 compartment with useful drum opening dimension of 400x315 mm

OPTIONS:

- Weight System (WS)
- Side Drain Valve (SDV)
- Detergent Box (DBX)
- Electric Battery Motor Brake (UPS)
- Motor Brake (BR)
- 6 extra dosage signals (XD)
- Second screen (2SC)
- 2nd Drain Valve (DD)
- Titration Valve (TV)
- Stainless Steel Case (SSC)
- Wooden Maritime Packaging (WM)
- Printer Kit (PR)
- Low Pressure Steam (LPS)
- Different voltage options.

"
"

DIMENSIONS

X Width	984 mm	X Gross width	1072 mm
Y Depth	914 mm	Y Gross depth	1102 mm
Z Height	1398 mm	Z Gross height	1530 mm
Net Weight	438,0 kg	Gross Weight	459,0 kg
Net volume	1,260 m3	Gross volume	1,807 m3

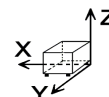

ELECTRICITY TECHNICAL SPECIFICATIONS

Engine power	2,20 kW
Electric power	14,200 kW
Amperage (A)	30/21A
Heating power	12,00 kW
Voltage	230/400V - 3/3N
Electric frequency	50/60Hz

STEAM TECHNICAL SPECIFICATIONS

Steam consumption	1,24 kg/h
Steam pressure	6,00 - 10,00 bar

WATER TECHNICAL SPECIFICATIONS

Pressure	H2O: 200-400kPa(2-4bar)
Water max consumption	144,00 L/h

CONNECTIONS TECHNICAL SPECIFICATIONS

230 V three-phase wiring	4 X 10 / 30A
Three-phase +N 400V wiring	5 X 6 / 21A
Steam entrance diameter	3/4"
Water inlet diameter	3/4"
Drain 1 diameter	3"
Drainage capacity	160 l/min

OTHERS

Load capacity 1/9	18,00 kg
Load capacity 1/10	16,00 kg
Drum volume	158 L
Drum diameter	633 mm
Drum depth	500 mm
Drum compartments	1
Wash speed	45,0 r.p.m.
Max revolutions	1000 r.p.m.
G Factor	350
Frequency of dynamic load (Hz)	16,70



Catalogue

Chapter

Model

LMED-16 TP2 ES 230...400V 3/3N 50/60Hz

19066873

10/02/2020

Noise level

68,00 dB

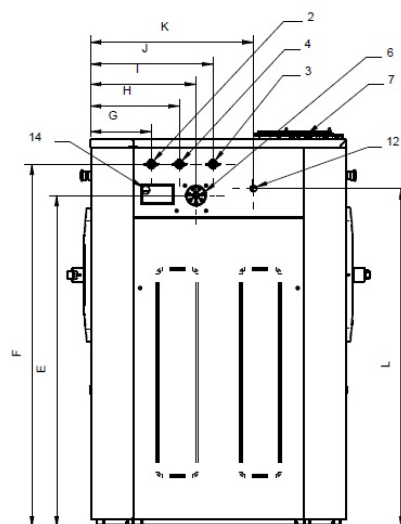
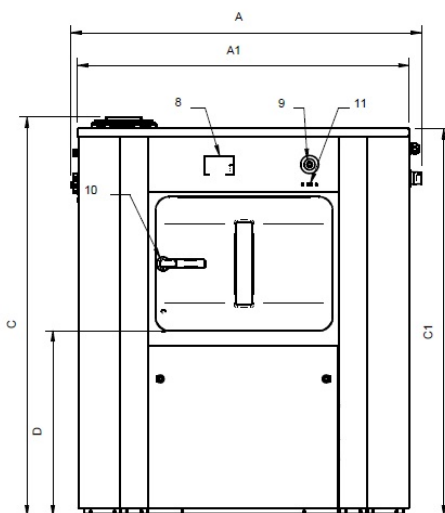
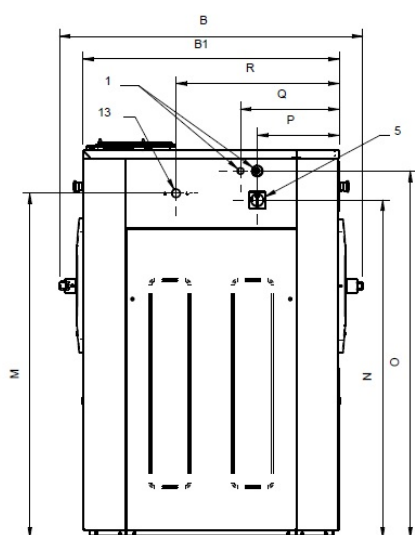

- 01. CONEXIÓN ELÉCTRICA
- 02. AGUA CALIENTE
- 03. AGUA FRÍA
- 04. AGUA DESCALCIFICADA
- 05. INTERRUPTOR GENERAL
- 06. ENTRADA PRODUCTOS LÍQUIDOS
- 07. JABONERA (OPCIÓN)
- 08. PANEL DE CONTROL
- 09. PARADA DE EMERGENCIA
- 10. APERTURA DE PUERTA
- 11. PUERTO USB
- 12. CONEXIÓN BOMBA DOSIFICADORA
- 13. ENTRADA VAPORES
- 14. SALIDA DE VAHOS

- 01. ELECTRICAL CONNEXION
- 02. HOT WATER
- 03. COLD WATER
- 04. SOFT WATER
- 05. MAIN SWITCH
- 06. LIQUID PRODUCTS INLET
- 07. DETERGENT BOX (OPTION)
- 08. CONTROL PANEL
- 09. EMERGENCY STOP
- 10. DOOR OPENING
- 11. USB PORT
- 12. DOSING PUMPS CONNEXION
- 13. STEAM INLET
- 14. EXHAUST

- 01. CONNEXION ELECTRIQUE
- 02. EAU CHAUDE
- 03. EAU FROIDE
- 04. EAU ADOUCIE
- 05. INTERRUPTEUR GENERAL
- 06. ENTREE PRODUITS LIQUIDES
- 07. BAC A PRODUITS (OPTION)
- 08. PANNEAU DE COMMANDE
- 09. ARRET D'URGENCE
- 10. OUVERTURE PORTE
- 11. PORT USB
- 12. CONNEXION POMPES DOSEUSES
- 13. ENTREE VAPEUR
- 14. EVENT

	A	B	C	A1	B1	C1	D	E	F	G	H	I	J	K	L	M	N	O	P	Q	R
LMED-16	1.054	1.082	1.426	984	914	1.385	661	1.184	1.296	217	317	377	437	582	1.209	1.231	1.207	1.311	292	352	582
LMED-22	1.254	1.082	1.426	1.184	914	1.385	661	1.184	1.296	217	317	377	437	582	1.209	1.231	1.207	1.311	292	352	582



Catalogue

Chapter

Model

LMED-16 TP2 S 230/400/440V 3N/3/1N 50/60

18002263

10/02/2020

SANITARY BARRIER WASHER EXTRACTOR, LMED-16 TP2 S

- New TP2 processor with 4.3" touch screen on the dirty side (optional on the clean side).
- 2 water inlets.
- External steel casing with grey coating (skinplate), stainless steel, easy to clean finish.
- Heating versions: electric and steam.
- Double heating version, selectable electric and steam.
- 29 programs pre-set from factory.
- Traceability as standard.
- 8 signals for automatic liquid dosing, programmable in time and delay.
- Optimum load. Intelligent weighing system.
- Possibility of configuring three levels of savings. 6 extra signals available optionally.
- Designed for water recovery tanks. Low water consumption.
- 1-compartment horizontal spin drum.
- Loading and unloading doors. Door locks with safety opening
- Electrical part to the left, mechanical to the right, connections at the top.
- Central drain.
- Technical menu. Statistics, alarms, autotest, data recovery for technicians and maintenance.
- Motor with variable-frequency drive incorporated.
- Prepared for Wet cleaning
- Steam heating version
- 1 compartment with useful drum opening dimension of 400x315 mm

OPTIONS:

- Weight System (WS)
- Side Drain Valve (SDV)
- Detergent Box (DBX)
- Electric Battery Motor Brake (UPS)
- Motor Brake (BR)
- 6 extra dosage signals (XD)
- Second screen (2SC)
- 2nd Drain Valve (DD)
- Titration Valve (TV)
- Stainless Steel Case (SSC)
- Wooden Maritime Packaging (WM)
- Printer Kit (PR)
- Low Pressure Steam (LPS)
- Different voltage options.

"
"

DIMENSIONS

X Width	984 mm	X Gross width	1072 mm
Y Depth	914 mm	Y Gross depth	1102 mm
Z Height	1398 mm	Z Gross height	1530 mm
Net Weight	438,0 kg	Gross Weight	459,0 kg
Net volume	1,260 m3	Gross volume	1,807 m3

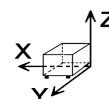

ELECTRICITY TECHNICAL SPECIFICATIONS

Engine power	2,20 kW
Electric power	2,200 kW
Amperage (A)	6A
Voltage	230/400/440V - 3N/3/1N
Electric frequency	50/60Hz

STEAM TECHNICAL SPECIFICATIONS

Steam consumption	1,24 kg/h
Steam pressure	6,00 - 10,00 bar

WATER TECHNICAL SPECIFICATIONS

Pressure	H2O: 200-400kPa(2-4bar)
Water max consumption	144,00 L/h

CONNECTIONS TECHNICAL SPECIFICATIONS

230 V three-phase wiring	4 X 2.5 / 6A
Three-phase +N 400V wiring	5 X 2.5 / 6A
Steam entrance diameter	3/4"
Water inlet diameter	3/4"
Drain 1 diameter	3"
Drainage capacity	160 l/min

OTHERS

Load capacity 1/9	18,00 kg
Load capacity 1/10	16,00 kg
Drum volume	158 L
Drum diameter	633 mm
Drum depth	500 mm
Drum compartments	1
Wash speed	45,0 r.p.m.
Max revolutions	1000 r.p.m.
G Factor	350
Frequency of dynamic load (Hz)	16,70
Noise level	68,00 dB



Catalogue

Chapter

Model

LMED-16 TP2 S 230/400/440V 3N/3/1N 50/60

18002263

10/02/2020

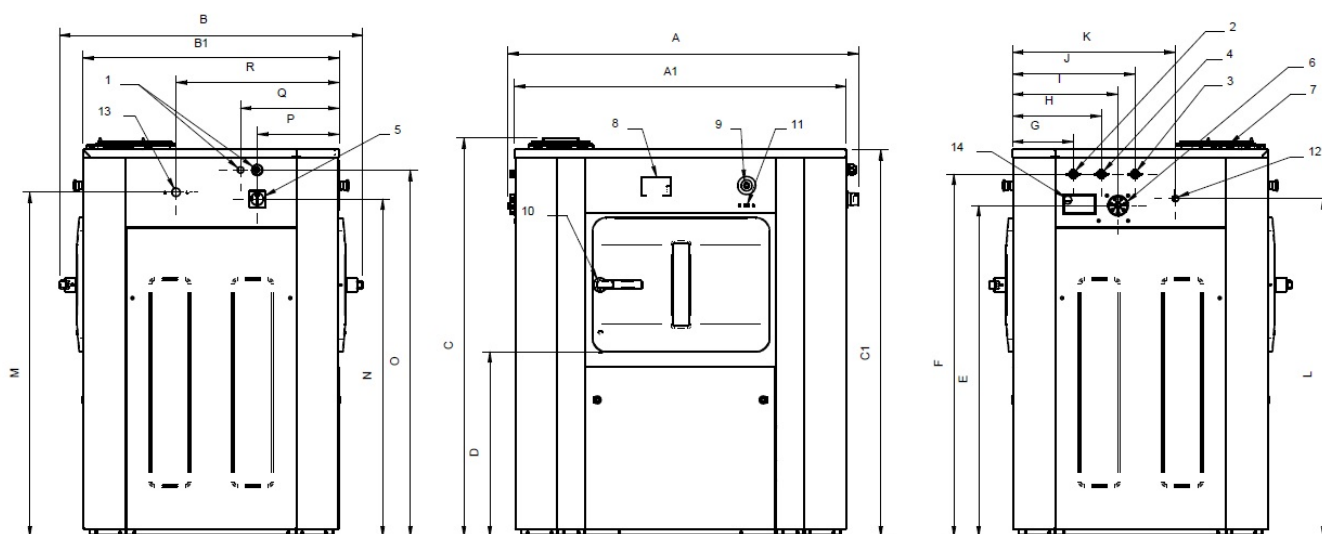

- 01. CONEXIÓN ELÉCTRICA
- 02. AGUA CALIENTE
- 03. AGUA FRÍA
- 04. AGUA DESCALCIFICADA
- 05. INTERRUPTOR GENERAL
- 06. ENTRADA PRODUCTOS LÍQUIDOS
- 07. JABONERA (OPCIÓN)
- 08. PANEL DE CONTROL
- 09. PARADA DE EMERGENCIA
- 10. APERTURA DE PUERTA
- 11. PUERTO USB
- 12. CONEXIÓN BOMBA DOSIFICADORA
- 13. ENTRADA VAPOR
- 14. SALIDA DE VAHOS

- 01. ELECTRICAL CONNEXION
- 02. HOT WATER
- 03. COLD WATER
- 04. SOFT WATER
- 05. MAIN SWITCH
- 06. LIQUID PRODUCTS INLET
- 07. DETERGENT BOX (OPTION)
- 08. CONTROL PANEL
- 09. EMERGENCY STOP
- 10. DOOR OPENING
- 11. USB PORT
- 12. DOSING PUMPS CONNEXION
- 13. STEAM INLET
- 14. EXHAUST

- 01. CONNEXION ELECTRIQUE
- 02. EAU CHAUDE
- 03. EAU FROIDE
- 04. EAU ADOUCIE
- 05. INTERRUPTEUR GENERAL
- 06. ENTREE PRODUITS LIQUIDES
- 07. BAC A PRODUITS (OPTION)
- 08. PANNEAU DE COMMANDE
- 09. ARRÊT D'URGENCE
- 10. OUVERTURE PORTE
- 11. PORT USB
- 12. CONNEXION POMPES DOSEUSES
- 13. ENTREE VAPEUR
- 14. EVENT

	A	B	C	A1	B1	C1	D	E	F	G	H	I	J	K	L	M	N	O	P	Q	R
LMED-16	1.054	1.082	1.426	984	914	1.385	661	1.184	1.296	217	317	377	437	582	1.209	1.231	1.207	1.311	292	352	582
LMED-22	1.254	1.082	1.426	1.184	914	1.385	661	1.184	1.296	217	317	377	437	582	1.209	1.231	1.207	1.311	292	352	582



Catalogue

Chapter

Model

LMED-16 TP2 S 230V 1N 50/60Hz

19066872

10/02/2020

SANITARY BARRIER WASHER EXTRACTOR, LMED-16 TP2 S

- New TP2 processor with 4.3" touch screen on the dirty side (optional on the clean side).
- 2 water inlets.
- External steel casing with grey coating (skinplate), stainless steel, easy to clean finish.
- Heating versions: electric and steam.
- Double heating version, selectable electric and steam.
- 29 programs pre-set from factory.
- Traceability as standard.
- 8 signals for automatic liquid dosing, programmable in time and delay.
- Optimum load. Intelligent weighing system.
- Possibility of configuring three levels of savings. 6 extra signals available optionally.
- Designed for water recovery tanks. Low water consumption.
- 1-compartment horizontal spin drum.
- Loading and unloading doors. Door locks with safety opening
- Electrical part to the left, mechanical to the right, connections at the top.
- Central drain.
- Technical menu. Statistics, alarms, autotest, data recovery for technicians and maintenance.
- Motor with variable-frequency drive incorporated.
- Prepared for Wet cleaning
- Steam heating version
- 1 compartment with useful drum opening dimension of 400x315 mm

OPTIONS:

- Weight System (WS)
- Side Drain Valve (SDV)
- Detergent Box (DBX)
- Electric Battery Motor Brake (UPS)
- Motor Brake (BR)
- 6 extra dosage signals (XD)
- Second screen (2SC)
- 2nd Drain Valve (DD)
- Titration Valve (TV)
- Stainless Steel Case (SSC)
- Wooden Maritime Packaging (WM)
- Printer Kit (PR)
- Low Pressure Steam (LPS)
- Different voltage options.

"
"

DIMENSIONS

X Width	984 mm	X Gross width	1072 mm
Y Depth	914 mm	Y Gross depth	1102 mm
Z Height	1398 mm	Z Gross height	1530 mm
Net Weight	438,0 kg	Gross Weight	459,0 kg
Net volume	1,260 m3	Gross volume	1,807 m3

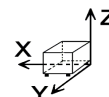

ELECTRICITY TECHNICAL SPECIFICATIONS

Engine power	2,20 kW
Electric power	2,200 kW
Amperage (A)	6A
Voltage	230V - 1N
Electric frequency	50/60Hz

STEAM TECHNICAL SPECIFICATIONS

Steam consumption	1,24 kg/h
Steam pressure	6,00 - 10,00 bar

WATER TECHNICAL SPECIFICATIONS

Pressure	H2O: 200-400kPa(2-4bar)
Water max consumption	144,00 L/h

CONNECTIONS TECHNICAL SPECIFICATIONS

230 V three-phase wiring	4 X 2.5 / 6A
Three-phase +N 400V wiring	5 X 2.5 / 6A
Steam entrance diameter	3/4"
Water inlet diameter	3/4"
Drain 1 diameter	3"
Drainage capacity	160 l/min

OTHERS

Load capacity 1/9	18,00 kg
Load capacity 1/10	16,00 kg
Drum volume	158 L
Drum diameter	633 mm
Drum depth	500 mm
Drum compartments	1
Wash speed	45,0 r.p.m.
Max revolutions	1000 r.p.m.
G Factor	350
Frequency of dynamic load (Hz)	16,70
Noise level	68,00 dB



Catalogue

Chapter

Model

LMED-16 TP2 S 230V 1N 50/60Hz

19066872

10/02/2020

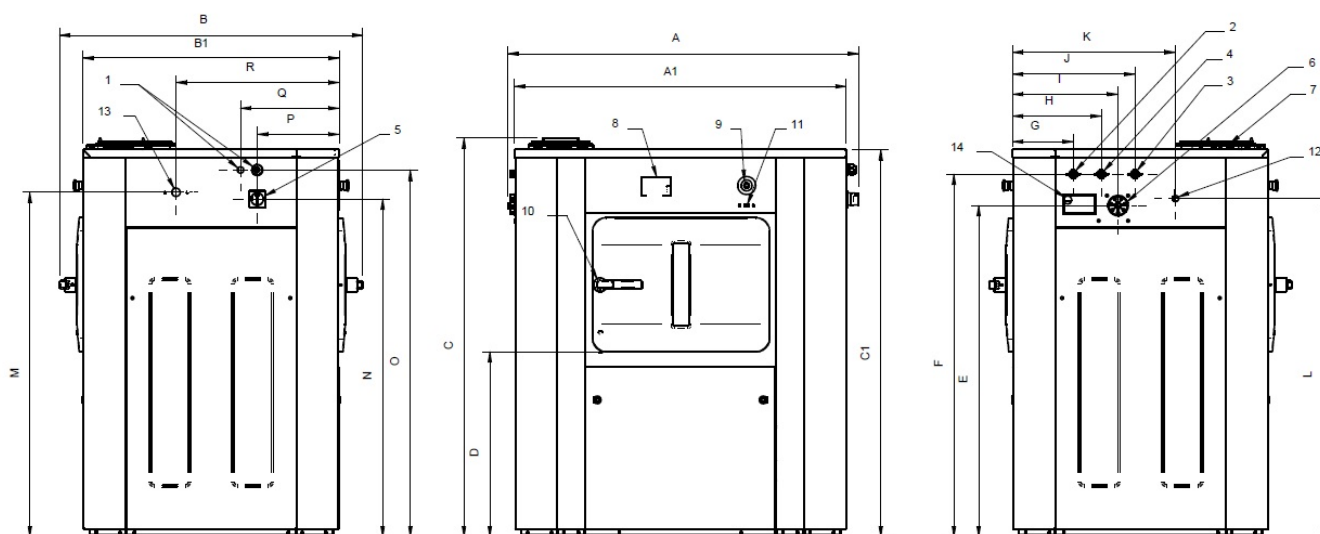

- 01. CONEXIÓN ELÉCTRICA
- 02. AGUA CALIENTE
- 03. AGUA FRÍA
- 04. AGUA DESCALCIFICADA
- 05. INTERRUPTOR GENERAL
- 06. ENTRADA PRODUCTOS LÍQUIDOS
- 07. JABONERA (OPCIÓN)
- 08. PANEL DE CONTROL
- 09. PARADA DE EMERGENCIA
- 10. APERTURA DE PUERTA
- 11. PUERTO USB
- 12. CONEXIÓN BOMBA DOSIFICADORA
- 13. ENTRADA VAPOR
- 14. SALIDA DE VAHOS

- 01. ELECTRICAL CONNEXION
- 02. HOT WATER
- 03. COLD WATER
- 04. SOFT WATER
- 05. MAIN SWITCH
- 06. LIQUID PRODUCTS INLET
- 07. DETERGENT BOX (OPTION)
- 08. CONTROL PANEL
- 09. EMERGENCY STOP
- 10. DOOR OPENING
- 11. USB PORT
- 12. DOSING PUMPS CONNEXION
- 13. STEAM INLET
- 14. EXHAUST

- 01. CONNEXION ELECTRIQUE
- 02. EAU CHAUDE
- 03. EAU FROIDE
- 04. EAU ADOUCIE
- 05. INTERRUPTEUR GENERAL
- 06. ENTREE PRODUITS LIQUIDES
- 07. BAC A PRODUITS (OPTION)
- 08. PANNEAU DE COMMANDE
- 09. ARRET D'URGENCE
- 10. OUVERTURE PORTE
- 11. PORT USB
- 12. CONNEXION POMPES DOSEUSES
- 13. ENTREE VAPEUR
- 14. EVENT

	A	B	C	A1	B1	C1	D	E	F	G	H	I	J	K	L	M	N	O	P	Q	R
LMED-16	1.054	1.082	1.426	984	914	1.385	661	1.184	1.296	217	317	377	437	582	1.209	1.231	1.207	1.311	292	352	582
LMED-22	1.254	1.082	1.426	1.184	914	1.385	661	1.184	1.296	217	317	377	437	582	1.209	1.231	1.207	1.311	292	352	582



Catalogue

Chapter

Model

LMED-22 TP2 E 230/400/440V 3N/3 50/60Hz

18002265

11/02/2020

SANITARY BARRIER WASHER EXTRACTOR, LMED-22 TP2 E

- New TP2 processor with 4.3" touch screen on the dirty side (optional on the clean side).
- 2 water inlets.
- External steel casing with grey coating (skinplate), stainless steel, easy to clean finish.
- Heating versions: electric and steam.
- Double heating version, selectable electric and steam.
- 29 programs pre-set from factory.
- Traceability as standard.
- 8 signals for automatic liquid dosing, programmable in time and delay.
- Optimum load. Intelligent weighing system.
- Possibility of configuring three levels of savings. 6 extra signals available optionally.
- Designed for water recovery tanks. Low water consumption.
- 1-compartment horizontal spin drum.
- Loading and unloading doors. Door locks with safety opening
- Electrical part to the left, mechanical to the right, connections at the top.
- Central drain.
- Technical menu. Statistics, alarms, autotest, data recovery for technicians and maintenance.
- Motor with variable-frequency drive incorporated.
- Prepared for Wet cleaning
- Electric heating version
- 1 compartment with useful drum opening dimension of 400x315 mm

OPTIONS:

- Weight System (WS)
- Side Drain Valve (SDV)
- Detergent Box (DBX)
- Electric Battery Motor Brake (UPS)
- Motor Brake (BR)
- 6 extra dosage signals (XD)
- Second screen (2SC)
- 2nd Drain Valve (DD)
- Titration Valve (TV)
- Stainless Steel Case (SSC)
- Wooden Maritime Packaging (WM)
- Printer Kit (PR)
- Low Pressure Steam (LPS)
- Different voltage options.

"
"

DIMENSIONS

X Width	1184 mm	X Gross width	1262 mm
Y Depth	914 mm	Y Gross depth	1102 mm
Z Height	1398 mm	Z Gross height	1530 mm
Net Weight	471,0 kg	Gross Weight	494,0 kg
Net volume	1,520 m3	Gross volume	2,128 m3

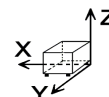

ELECTRICITY TECHNICAL SPECIFICATIONS

Engine power	2,20 kW
Electric power	20,200 kW
Amperage (A)	53/30A
Heating power	18,00 kW
Voltage	230/400/440V - 3N/3
Electric frequency	50/60Hz

WATER TECHNICAL SPECIFICATIONS

Pressure	H2O: 200-400kPa(2-4bar)
Water max consumption	231,00 L/h

CONNECTIONS TECHNICAL SPECIFICATIONS

230 V three-phase wiring	4 X 10 / 63A
Three-phase +N 400V wiring	5 X 6 / 32A
Water inlet diameter	3/4"
Drain 1 diameter	3"
Drainage capacity	160 l/min

OTHERS

Load capacity 1/9	24,00 kg
Load capacity 1/10	22,00 kg
Drum volume	220 L
Drum diameter	633 mm
Drum depth	700 mm
Drum compartments	1
Wash speed	45,0 r.p.m.
Max revolutions	1000 r.p.m.
G Factor	350
Frequency of dynamic load (Hz)	16,70
Noise level	65,00 dB



Catalogue

Chapter

Model

LMED-22 TP2 E 230/400/440V 3N/3 50/60Hz

18002265

11/02/2020

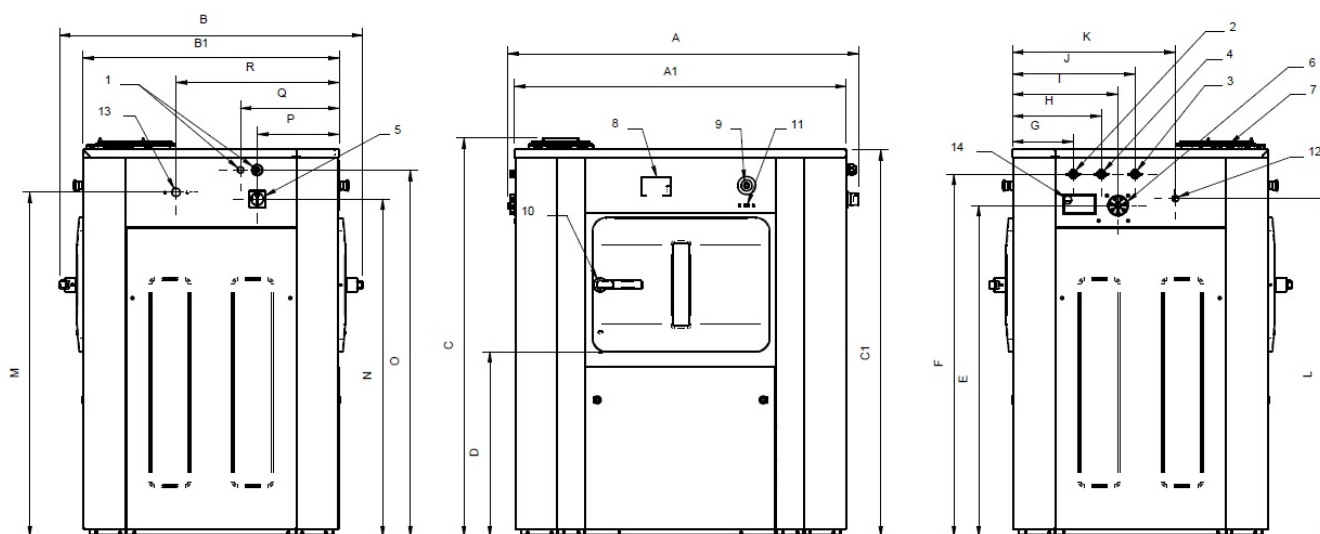

- 01. CONEXIÓN ELÉCTRICA
- 02. AGUA CALIENTE
- 03. AGUA FRÍA
- 04. AGUA DESCALCIFICADA
- 05. INTERRUPTOR GENERAL
- 06. ENTRADA PRODUCTOS LÍQUIDOS
- 07. JABONERA (OPCIÓN)
- 08. PANEL DE CONTROL
- 09. PARADA DE EMERGENCIA
- 10. APERTURA DE PUERTA
- 11. PUERTO USB
- 12. CONEXIÓN BOMBA DOSIFICADORA
- 13. ENTRADA VAPOR
- 14. SALIDA DE VAHOS

- 01. ELECTRICAL CONNEXION
- 02. HOT WATER
- 03. COLD WATER
- 04. SOFT WATER
- 05. MAIN SWITCH
- 06. LIQUID PRODUCTS INLET
- 07. DETERGENT BOX (OPTION)
- 08. CONTROL PANEL
- 09. EMERGENCY STOP
- 10. DOOR OPENING
- 11. USB PORT
- 12. DOSING PUMPS CONNEXION
- 13. STEAM INLET
- 14. EXHAUST

- 01. CONNEXION ELECTRIQUE
- 02. EAU CHAUDE
- 03. EAU FROIDE
- 04. EAU ADOUCIE
- 05. INTERRUPTEUR GENERAL
- 06. ENTREE PRODUITS LIQUIDES
- 07. BAC A PRODUITS (OPTION)
- 08. PANNEAU DE COMMANDE
- 09. ARRET D'URGENCE
- 10. OUVERTURE PORTE
- 11. PORT USB
- 12. CONNEXION POMPES DOSEUSES
- 13. ENTREE VAPEUR
- 14. EVENT

	A	B	C	A1	B1	C1	D	E	F	G	H	I	J	K	L	M	N	O	P	Q	R
LMED-16	1.054	1.082	1.426	984	914	1.385	661	1.184	1.296	217	317	377	437	582	1.209	1.231	1.207	1.311	292	352	582
LMED-22	1.254	1.082	1.426	1.184	914	1.385	661	1.184	1.296	217	317	377	437	582	1.209	1.231	1.207	1.311	292	352	582



Catalogue

Chapter

Model

LMED-22 TP2 E 230...400V 3/3N 50/60Hz

19066874

11/02/2020

SANITARY BARRIER WASHER EXTRACTOR, LMED-22 TP2 E

- New TP2 processor with 4.3" touch screen on the dirty side (optional on the clean side).
- 2 water inlets.
- External steel casing with grey coating (skinplate), stainless steel, easy to clean finish.
- Heating versions: electric and steam.
- Double heating version, selectable electric and steam.
- 29 programs pre-set from factory.
- Traceability as standard.
- 8 signals for automatic liquid dosing, programmable in time and delay.
- Optimum load. Intelligent weighing system.
- Possibility of configuring three levels of savings. 6 extra signals available optionally.
- Designed for water recovery tanks. Low water consumption.
- 1-compartment horizontal spin drum.
- Loading and unloading doors. Door locks with safety opening
- Electrical part to the left, mechanical to the right, connections at the top.
- Central drain.
- Technical menu. Statistics, alarms, autotest, data recovery for technicians and maintenance.
- Motor with variable-frequency drive incorporated.
- Prepared for Wet cleaning
- Electric heating version
- 1 compartment with useful drum opening dimension of 400x315 mm

OPTIONS:

- Weight System (WS)
- Side Drain Valve (SDV)
- Detergent Box (DBX)
- Electric Battery Motor Brake (UPS)
- Motor Brake (BR)
- 6 extra dosage signals (XD)
- Second screen (2SC)
- 2nd Drain Valve (DD)
- Titration Valve (TV)
- Stainless Steel Case (SSC)
- Wooden Maritime Packaging (WM)
- Printer Kit (PR)
- Low Pressure Steam (LPS)
- Different voltage options.

"
"

DIMENSIONS

X Width	1184 mm	X Gross width	1262 mm
Y Depth	914 mm	Y Gross depth	1102 mm
Z Height	1398 mm	Z Gross height	1530 mm
Net Weight	471,0 kg	Gross Weight	494,0 kg
Net volume	1,520 m3	Gross volume	2,128 m3

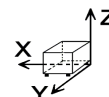

ELECTRICITY TECHNICAL SPECIFICATIONS

Engine power	2,20 kW
Electric power	20,200 kW
Amperage (A)	53/30A
Heating power	18,00 kW
Voltage	230/400V - 3/3N
Electric frequency	50/60Hz

WATER TECHNICAL SPECIFICATIONS

Pressure	H2O: 200-400kPa(2-4bar)
Water max consumption	231,00 L/h

CONNECTIONS TECHNICAL SPECIFICATIONS

230 V three-phase wiring	4 X 10 / 63A
Three-phase +N 400V wiring	5 X 6 / 32A
Water inlet diameter	3/4"
Drain 1 diameter	3"
Drainage capacity	160 l/min

OTHERS

Load capacity 1/9	24,00 kg
Load capacity 1/10	22,00 kg
Drum volume	220 L
Drum diameter	633 mm
Drum depth	700 mm
Drum compartments	1
Wash speed	45,0 r.p.m.
Max revolutions	1000 r.p.m.
G Factor	350
Frequency of dynamic load (Hz)	16,70
Noise level	65,00 dB



Catalogue

Chapter

Model

LMED-22 TP2 E 230...400V 3/3N 50/60Hz

19066874

11/02/2020

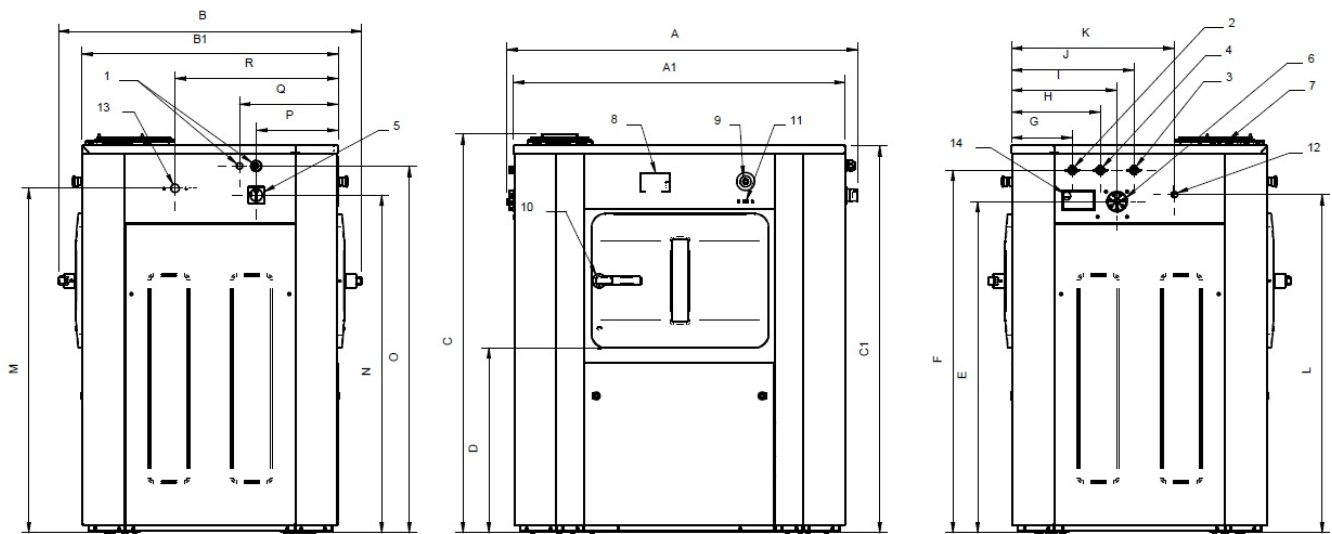

- 01. CONEXIÓN ELÉCTRICA
- 02. AGUA CALIENTE
- 03. AGUA FRÍA
- 04. AGUA DESCALCIFICADA
- 05. INTERRUPTOR GENERAL
- 06. ENTRADA PRODUCTOS LÍQUIDOS
- 07. JABONERA (OPCIÓN)
- 08. PANEL DE CONTROL
- 09. PARADA DE EMERGENCIA
- 10. APERTURA DE PUERTA
- 11. PUERTO USB
- 12. CONEXIÓN BOMBA DOSIFICADORA
- 13. ENTRADA VAPOR
- 14. SALIDA DE VAHOS

- 01. ELECTRICAL CONNEXION
- 02. HOT WATER
- 03. COLD WATER
- 04. SOFT WATER
- 05. MAIN SWITCH
- 06. LIQUID PRODUCTS INLET
- 07. DETERGENT BOX (OPTION)
- 08. CONTROL PANEL
- 09. EMERGENCY STOP
- 10. DOOR OPENING
- 11. USB PORT
- 12. DOSING PUMPS CONNEXION
- 13. STEAM INLET
- 14. EXHAUST

- 01. CONNEXION ELECTRIQUE
- 02. EAU CHAUDE
- 03. EAU FROIDE
- 04. EAU ADOUCIE
- 05. INTERRUPTEUR GENERAL
- 06. ENTREE PRODUITS LIQUIDES
- 07. BAC A PRODUITS (OPTION)
- 08. PANNEAU DE COMMANDE
- 09. ARRÊT D'URGENCE
- 10. OUVERTURE PORTE
- 11. PORT USB
- 12. CONNEXION POMPES DOSEUSES
- 13. ENTREE VAPEUR
- 14. EVENT

	A	B	C	A1	B1	C1	D	E	F	G	H	I	J	K	L	M	N	O	P	Q	R
LMED-16	1.054	1.082	1.426	984	914	1.385	661	1.184	1.296	217	317	377	437	582	1.209	1.231	1.207	1.311	292	352	582
LMED-22	1.254	1.082	1.426	1.184	914	1.385	661	1.184	1.296	217	317	377	437	582	1.209	1.231	1.207	1.311	292	352	582



Catalogue

Chapter

Model

LMED-22 TP2 ES 230/400/440V 3N/3 50/60Hz

18002267

10/02/2020

SANITARY BARRIER WASHER EXTRACTOR, LMED-22 TP2 ES

- New TP2 processor with 4.3" touch screen on the dirty side (optional on the clean side).
- 2 water inlets.
- External steel casing with grey coating (skinplate), stainless steel, easy to clean finish.
- Heating versions: electric and steam.
- Double heating version, selectable electric and steam.
- 29 programs pre-set from factory.
- Traceability as standard.
- 8 signals for automatic liquid dosing, programmable in time and delay.
- Optimum load. Intelligent weighing system.
- Possibility of configuring three levels of savings. 6 extra signals available optionally.
- Designed for water recovery tanks. Low water consumption.
- 1-compartment horizontal spin drum.
- Loading and unloading doors. Door locks with safety opening
- Electrical part to the left, mechanical to the right, connections at the top.
- Central drain.
- Technical menu. Statistics, alarms, autotest, data recovery for technicians and maintenance.
- Motor with variable-frequency drive incorporated.
- Prepared for Wet cleaning
- Double heating version, selectionable between steam or electric
- 1 compartment with useful drum opening dimension of 400x315 mm

OPTIONS:

- Weight System (WS)
- Side Drain Valve (SDV)
- Detergent Box (DBX)
- Electric Battery Motor Brake (UPS)
- Motor Brake (BR)
- 6 extra dosage signals (XD)
- Second screen (2SC)
- 2nd Drain Valve (DD)
- Titration Valve (TV)
- Stainless Steel Case (SSC)
- Wooden Maritime Packaging (WM)
- Printer Kit (PR)
- Low Pressure Steam (LPS)
- Different voltage options.

"
"

DIMENSIONS

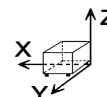

X Width	1184 mm	X Gross width	1262 mm
Y Depth	914 mm	Y Gross depth	1102 mm
Z Height	1398 mm	Z Gross height	1530 mm
Net Weight	471,0 kg	Gross Weight	494,0 kg
Net volume	1,520 m3	Gross volume	2,128 m3

ELECTRICITY TECHNICAL SPECIFICATIONS

Engine power	2,20 kW
Electric power	20,200 kW
Amperage (A)	30/21A
Heating power	18,00 kW
Voltage	230/400/440V - 3N/3
Electric frequency	50/60Hz

STEAM TECHNICAL SPECIFICATIONS

Steam consumption	1,69 kg/h
Steam pressure	6,00 - 10,00 bar

WATER TECHNICAL SPECIFICATIONS

Pressure	H2O: 200-400kPa(2-4bar)
Water max consumption	231,00 L/h

CONNECTIONS TECHNICAL SPECIFICATIONS

230 V three-phase wiring	4 X 10 / 63A
Three-phase +N 400V wiring	5 X 6 / 32A
Steam entrance diameter	3/4"
Water inlet diameter	3/4"
Drain 1 diameter	3"
Drainage capacity	160 l/min

OTHERS

Load capacity 1/9	24,00 kg
Load capacity 1/10	22,00 kg
Drum volume	220 L
Drum diameter	633 mm
Drum depth	700 mm
Drum compartments	1
Wash speed	45,0 r.p.m.
Max revolutions	1000 r.p.m.
G Factor	350
Frequency of dynamic load (Hz)	16,70



Catalogue

Chapter

Model
LMED-22 TP2 ES 230/400/440V 3N/3 50/60Hz

18002267

10/02/2020

Noise level

68,00 dB

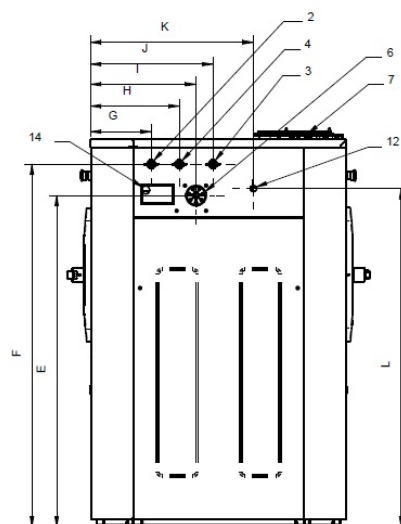
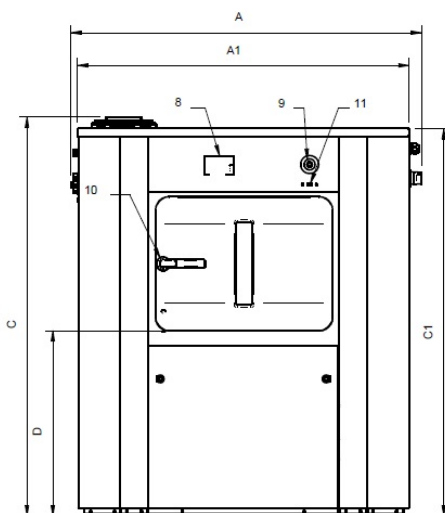
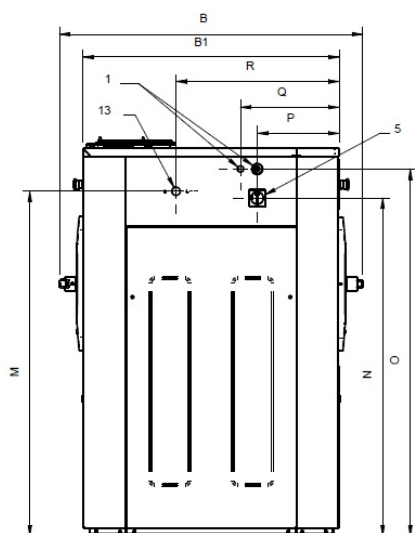

- 01. CONEXIÓN ELÉCTRICA
- 02. AGUA CALIENTE
- 03. AGUA FRÍA
- 04. AGUA DESCALCIFICADA
- 05. INTERRUPTOR GENERAL
- 06. ENTRADA PRODUCTOS LÍQUIDOS
- 07. JABONERA (OPCIÓN)
- 08. PANEL DE CONTROL
- 09. PARADA DE EMERGENCIA
- 10. APERTURA DE PUERTA
- 11. PUERTO USB
- 12. CONEXIÓN BOMBA DOSIFICADORA
- 13. ENTRADA VAPORES
- 14. SALIDA DE VAHOS

- 01. ELECTRICAL CONNEXION
- 02. HOT WATER
- 03. COLD WATER
- 04. SOFT WATER
- 05. MAIN SWITCH
- 06. LIQUID PRODUCTS INLET
- 07. DETERGENT BOX (OPTION)
- 08. CONTROL PANEL
- 09. EMERGENCY STOP
- 10. DOOR OPENING
- 11. USB PORT
- 12. DOSING PUMPS CONNEXION
- 13. STEAM INLET
- 14. EXHAUST

- 01. CONNEXION ELECTRIQUE
- 02. EAU CHAUDE
- 03. EAU FROIDE
- 04. EAU ADOUCIE
- 05. INTERRUPTEUR GENERAL
- 06. ENTREE PRODUITS LIQUIDES
- 07. BAC A PRODUITS (OPTION)
- 08. PANNEAU DE COMMANDE
- 09. ARRET D'URGENCE
- 10. OUVERTURE PORTE
- 11. PORT USB
- 12. CONNEXION POMPES DOSEUSES
- 13. ENTREE VAPEUR
- 14. EVENT

	A	B	C	A1	B1	C1	D	E	F	G	H	I	J	K	L	M	N	O	P	Q	R
LMED-16	1.054	1.082	1.426	984	914	1.385	661	1.184	1.296	217	317	377	437	582	1.209	1.231	1.207	1.311	292	352	582
LMED-22	1.254	1.082	1.426	1.184	914	1.385	661	1.184	1.296	217	317	377	437	582	1.209	1.231	1.207	1.311	292	352	582



Catalogue

Chapter

Model

LMED-22 TP2 ES 230...400V 3/3N 50/60Hz

19066876

10/02/2020

SANITARY BARRIER WASHER EXTRACTOR, LMED-22 TP2 ES

- New TP2 processor with 4.3" touch screen on the dirty side (optional on the clean side).
- 2 water inlets.
- External steel casing with grey coating (skinplate), stainless steel, easy to clean finish.
- Heating versions: electric and steam.
- Double heating version, selectable electric and steam.
- 29 programs pre-set from factory.
- Traceability as standard.
- 8 signals for automatic liquid dosing, programmable in time and delay.
- Optimum load. Intelligent weighing system.
- Possibility of configuring three levels of savings. 6 extra signals available optionally.
- Designed for water recovery tanks. Low water consumption.
- 1-compartment horizontal spin drum.
- Loading and unloading doors. Door locks with safety opening
- Electrical part to the left, mechanical to the right, connections at the top.
- Central drain.
- Technical menu. Statistics, alarms, autotest, data recovery for technicians and maintenance.
- Motor with variable-frequency drive incorporated.
- Prepared for Wet cleaning
- Double heating version, selectionable between steam or electric
- 1 compartment with useful drum opening dimension of 400x315 mm

OPTIONS:

- Weight System (WS)
- Side Drain Valve (SDV)
- Detergent Box (DBX)
- Electric Battery Motor Brake (UPS)
- Motor Brake (BR)
- 6 extra dosage signals (XD)
- Second screen (2SC)
- 2nd Drain Valve (DD)
- Titration Valve (TV)
- Stainless Steel Case (SSC)
- Wooden Maritime Packaging (WM)
- Printer Kit (PR)
- Low Pressure Steam (LPS)
- Different voltage options.

"
"

DIMENSIONS

X Width	1184 mm	X Gross width	1262 mm
Y Depth	914 mm	Y Gross depth	1102 mm
Z Height	1398 mm	Z Gross height	1530 mm
Net Weight	471,0 kg	Gross Weight	494,0 kg
Net volume	1,520 m3	Gross volume	2,128 m3

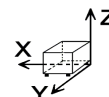

ELECTRICITY TECHNICAL SPECIFICATIONS

Engine power	2,20 kW
Electric power	20,200 kW
Amperage (A)	30/21A
Heating power	18,00 kW
Voltage	230/400V - 3/3N
Electric frequency	50/60Hz

STEAM TECHNICAL SPECIFICATIONS

Steam consumption	1,69 kg/h
Steam pressure	6,00 - 10,00 bar

WATER TECHNICAL SPECIFICATIONS

Pressure	H2O: 200-400kPa(2-4bar)
Water max consumption	231,00 L/h

CONNECTIONS TECHNICAL SPECIFICATIONS

230 V three-phase wiring	4 X 10 / 63A
Three-phase +N 400V wiring	5 X 6 / 32A
Steam entrance diameter	3/4"
Water inlet diameter	3/4"
Drain 1 diameter	3"
Drainage capacity	160 l/min

OTHERS

Load capacity 1/9	24,00 kg
Load capacity 1/10	22,00 kg
Drum volume	220 L
Drum diameter	633 mm
Drum depth	700 mm
Drum compartments	1
Wash speed	45,0 r.p.m.
Max revolutions	1000 r.p.m.
G Factor	350
Frequency of dynamic load (Hz)	16,70



Catalogue

Chapter

Model

LMED-22 TP2 ES 230...400V 3/3N 50/60Hz

19066876

10/02/2020

Noise level

68,00 dB

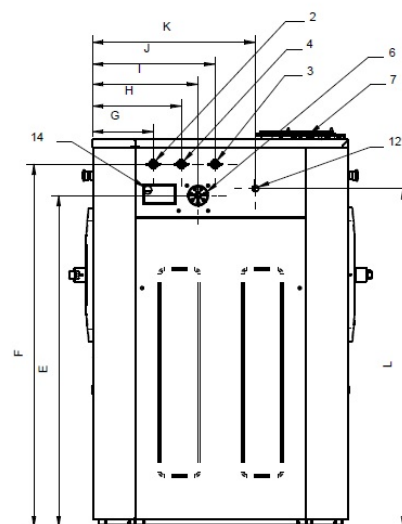
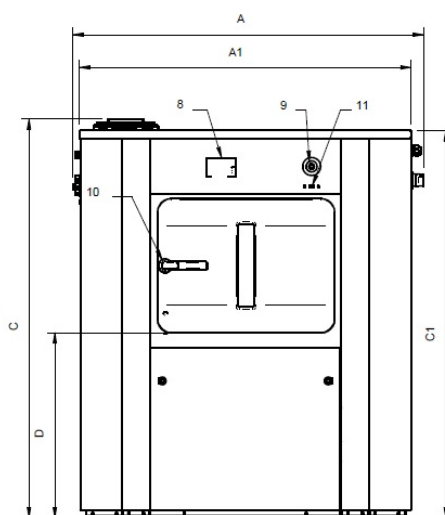
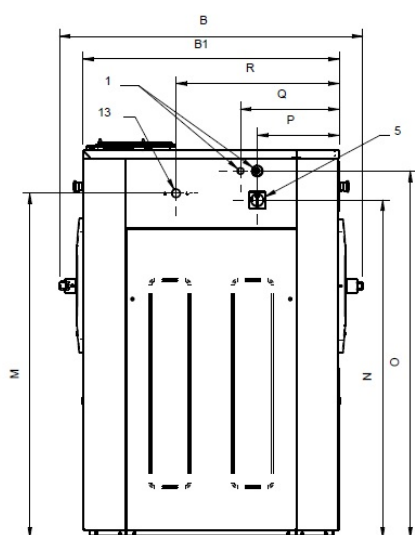

- 01. CONEXIÓN ELÉCTRICA
- 02. AGUA CALIENTE
- 03. AGUA FRÍA
- 04. AGUA DESCALCIFICADA
- 05. INTERRUPTOR GENERAL
- 06. ENTRADA PRODUCTOS LÍQUIDOS
- 07. JABONERA (OPCIÓN)
- 08. PANEL DE CONTROL
- 09. PARADA DE EMERGENCIA
- 10. APERTURA DE PUERTA
- 11. PUERTO USB
- 12. CONEXIÓN BOMBA DOSIFICADORA
- 13. ENTRADA VAPORES
- 14. SALIDA DE VAHOS

- 01. ELECTRICAL CONNEXION
- 02. HOT WATER
- 03. COLD WATER
- 04. SOFT WATER
- 05. MAIN SWITCH
- 06. LIQUID PRODUCTS INLET
- 07. DETERGENT BOX (OPTION)
- 08. CONTROL PANEL
- 09. EMERGENCY STOP
- 10. DOOR OPENING
- 11. USB PORT
- 12. DOSING PUMPS CONNEXION
- 13. STEAM INLET
- 14. EXHAUST

- 01. CONNEXION ELECTRIQUE
- 02. EAU CHAUDE
- 03. EAU FROIDE
- 04. EAU ADOUCIE
- 05. INTERRUPTEUR GENERAL
- 06. ENTREE PRODUITS LIQUIDES
- 07. BAC A PRODUITS (OPTION)
- 08. PANNEAU DE COMMANDE
- 09. ARRET D'URGENCE
- 10. OUVERTURE PORTE
- 11. PORT USB
- 12. CONNEXION POMPES DOSEUSES
- 13. ENTREE VAPEUR
- 14. EVENT

	A	B	C	A1	B1	C1	D	E	F	G	H	I	J	K	L	M	N	O	P	Q	R
LMED-16	1.054	1.082	1.426	984	914	1.385	661	1.184	1.296	217	317	377	437	582	1.209	1.231	1.207	1.311	292	352	582
LMED-22	1.254	1.082	1.426	1.184	914	1.385	661	1.184	1.296	217	317	377	437	582	1.209	1.231	1.207	1.311	292	352	582



Catalogue

Chapter

Model

LMED-22 TP2 S 230/400/440V 3N/3/1N 50/60

18002266

10/02/2020

SANITARY BARRIER WASHER EXTRACTOR, LMED-22 TP2 S

- New TP2 processor with 4.3" touch screen on the dirty side (optional on the clean side).
- 2 water inlets.
- External steel casing with grey coating (skinplate), stainless steel, easy to clean finish.
- Heating versions: electric and steam.
- Double heating version, selectable electric and steam.
- 29 programs pre-set from factory.
- Traceability as standard.
- 8 signals for automatic liquid dosing, programmable in time and delay.
- Optimum load. Intelligent weighing system.
- Possibility of configuring three levels of savings. 6 extra signals available optionally.
- Designed for water recovery tanks. Low water consumption.
- 1-compartment horizontal spin drum.
- Loading and unloading doors. Door locks with safety opening
- Electrical part to the left, mechanical to the right, connections at the top.
- Central drain.
- Technical menu. Statistics, alarms, autotest, data recovery for technicians and maintenance.
- Motor with variable-frequency drive incorporated.
- Prepared for Wet cleaning
- Steam heating version
- 1 compartment with useful drum opening dimension of 400x315 mm

OPTIONS:

- Weight System (WS)
- Side Drain Valve (SDV)
- Detergent Box (DBX)
- Electric Battery Motor Brake (UPS)
- Motor Brake (BR)
- 6 extra dosage signals (XD)
- Second screen (2SC)
- 2nd Drain Valve (DD)
- Titration Valve (TV)
- Stainless Steel Case (SSC)
- Wooden Maritime Packaging (WM)
- Printer Kit (PR)
- Low Pressure Steam (LPS)
- Different voltage options.

"
"

DIMENSIONS

X Width	1184 mm	X Gross width	1262 mm
Y Depth	914 mm	Y Gross depth	1102 mm
Z Height	1398 mm	Z Gross height	1530 mm
Net Weight	471,0 kg	Gross Weight	494,0 kg
Net volume	1,520 m3	Gross volume	2,128 m3

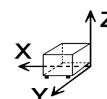

ELECTRICITY TECHNICAL SPECIFICATIONS

Engine power	2,20 kW
Electric power	2,200 kW
Amperage (A)	6A
Voltage	230/400/440V - 3N/3/1N
Electric frequency	50/60Hz

STEAM TECHNICAL SPECIFICATIONS

Steam consumption	1,69 kg/h
Steam pressure	6,00 - 10,00 bar

WATER TECHNICAL SPECIFICATIONS

Pressure	H2O: 200-400kPa(2-4bar)
Water max consumption	231,00 L/h

CONNECTIONS TECHNICAL SPECIFICATIONS

230 V three-phase wiring	4 X 2.5 / 6A
Three-phase +N 400V wiring	5 X 2.5 / 6A
Steam entrance diameter	3/4"
Water inlet diameter	3/4"
Drain 1 diameter	3"
Drainage capacity	160 l/min

OTHERS

Load capacity 1/9	24,00 kg
Load capacity 1/10	22,00 kg
Drum volume	220 L
Drum diameter	633 mm
Drum depth	700 mm
Drum compartments	1
Wash speed	45,0 r.p.m.
Max revolutions	1000 r.p.m.
G Factor	350
Frequency of dynamic load (Hz)	16,70
Noise level	68,00 dB



Catalogue

Chapter

Model

LMED-22 TP2 S 230/400/440V 3N/3/1N 50/60

18002266

10/02/2020

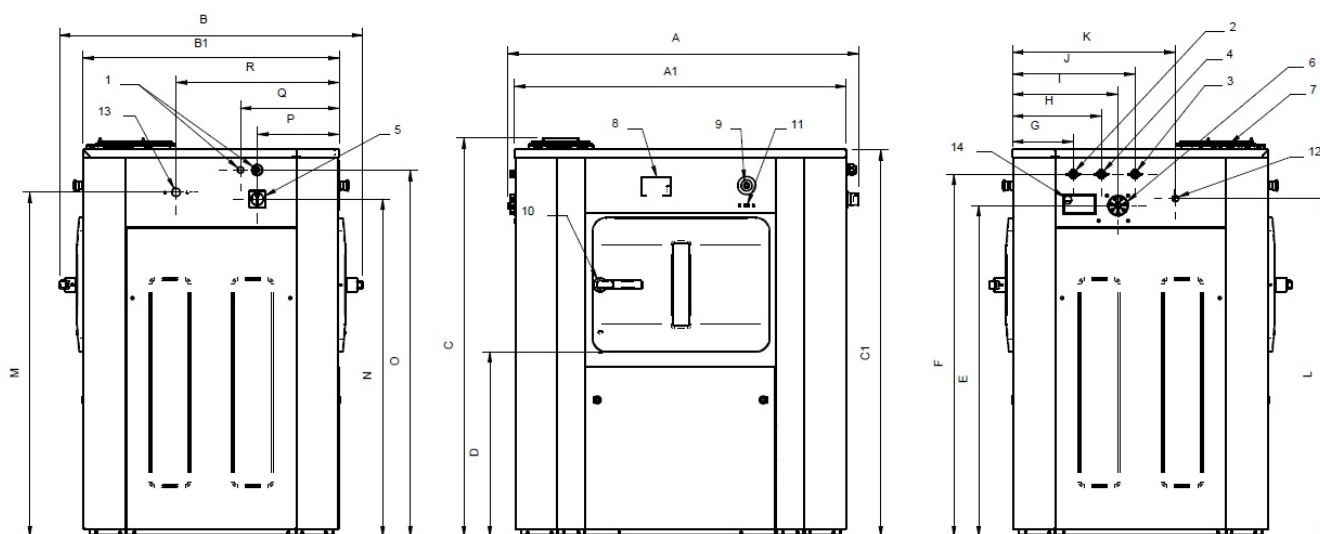

- 01. CONEXIÓN ELÉCTRICA
- 02. AGUA CALIENTE
- 03. AGUA FRÍA
- 04. AGUA DESCALCIFICADA
- 05. INTERRUPTOR GENERAL
- 06. ENTRADA PRODUCTOS LÍQUIDOS
- 07. JABONERA (OPCIÓN)
- 08. PANEL DE CONTROL
- 09. PARADA DE EMERGENCIA
- 10. APERTURA DE PUERTA
- 11. PUERTO USB
- 12. CONEXIÓN BOMBA DOSIFICADORA
- 13. ENTRADA VAPOR
- 14. SALIDA DE VAHOS

- 01. ELECTRICAL CONNEXION
- 02. HOT WATER
- 03. COLD WATER
- 04. SOFT WATER
- 05. MAIN SWITCH
- 06. LIQUID PRODUCTS INLET
- 07. DETERGENT BOX (OPTION)
- 08. CONTROL PANEL
- 09. EMERGENCY STOP
- 10. DOOR OPENING
- 11. USB PORT
- 12. DOSING PUMPS CONNEXION
- 13. STEAM INLET
- 14. EXHAUST

- 01. CONNEXION ELECTRIQUE
- 02. EAU CHAUDE
- 03. EAU FROIDE
- 04. EAU ADOUCIE
- 05. INTERRUPTEUR GENERAL
- 06. ENTREE PRODUITS LIQUIDES
- 07. BAC A PRODUITS (OPTION)
- 08. PANNEAU DE COMMANDE
- 09. ARRÊT D'URGENCE
- 10. OUVERTURE PORTE
- 11. PORT USB
- 12. CONNEXION POMPES DOSEUSES
- 13. ENTREE VAPEUR
- 14. EVENT

	A	B	C	A1	B1	C1	D	E	F	G	H	I	J	K	L	M	N	O	P	Q	R
LMED-16	1.054	1.082	1.426	984	914	1.385	661	1.184	1.296	217	317	377	437	582	1.209	1.231	1.207	1.311	292	352	582
LMED-22	1.254	1.082	1.426	1.184	914	1.385	661	1.184	1.296	217	317	377	437	582	1.209	1.231	1.207	1.311	292	352	582



Catalogue

Chapter

Model

LMED-22 TP2 S 230V 1N 50/60Hz

19066875

10/02/2020

SANITARY BARRIER WASHER EXTRACTOR, LMED-22 TP2 S

- New TP2 processor with 4.3" touch screen on the dirty side (optional on the clean side).
- 2 water inlets.
- External steel casing with grey coating (skinplate), stainless steel, easy to clean finish.
- Heating versions: electric and steam.
- Double heating version, selectable electric and steam.
- 29 programs pre-set from factory.
- Traceability as standard.
- 8 signals for automatic liquid dosing, programmable in time and delay.
- Optimum load. Intelligent weighing system.
- Possibility of configuring three levels of savings. 6 extra signals available optionally.
- Designed for water recovery tanks. Low water consumption.
- 1-compartment horizontal spin drum.
- Loading and unloading doors. Door locks with safety opening
- Electrical part to the left, mechanical to the right, connections at the top.
- Central drain.
- Technical menu. Statistics, alarms, autotest, data recovery for technicians and maintenance.
- Motor with variable-frequency drive incorporated.
- Prepared for Wet cleaning
- Steam heating version
- 1 compartment with useful drum opening dimension of 400x315 mm

OPTIONS:

- Weight System (WS)
- Side Drain Valve (SDV)
- Detergent Box (DBX)
- Electric Battery Motor Brake (UPS)
- Motor Brake (BR)
- 6 extra dosage signals (XD)
- Second screen (2SC)
- 2nd Drain Valve (DD)
- Titration Valve (TV)
- Stainless Steel Case (SSC)
- Wooden Maritime Packaging (WM)
- Printer Kit (PR)
- Low Pressure Steam (LPS)
- Different voltage options.

"
"

DIMENSIONS

X Width	1184 mm	X Gross width	1262 mm
Y Depth	914 mm	Y Gross depth	1102 mm
Z Height	1398 mm	Z Gross height	1530 mm
Net Weight	471,0 kg	Gross Weight	494,0 kg
Net volume	1,520 m3	Gross volume	2,128 m3

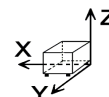

ELECTRICITY TECHNICAL SPECIFICATIONS

Engine power	2,20 kW
Electric power	2,200 kW
Amperage (A)	6A
Voltage	230V - 1N
Electric frequency	50/60Hz

STEAM TECHNICAL SPECIFICATIONS

Steam consumption	1,69 kg/h
Steam pressure	6,00 - 10,00 bar

WATER TECHNICAL SPECIFICATIONS

Pressure	H2O: 200-400kPa(2-4bar)
Water max consumption	231,00 L/h

CONNECTIONS TECHNICAL SPECIFICATIONS

230 V three-phase wiring	4 X 2.5 / 6A
Three-phase +N 400V wiring	5 X 2.5 / 6A
Steam entrance diameter	3/4"
Water inlet diameter	3/4"
Drain 1 diameter	3"
Drainage capacity	160 l/min

OTHERS

Load capacity 1/9	24,00 kg
Load capacity 1/10	22,00 kg
Drum volume	220 L
Drum diameter	633 mm
Drum depth	700 mm
Drum compartments	1
Wash speed	45,0 r.p.m.
Max revolutions	1000 r.p.m.
G Factor	350
Frequency of dynamic load (Hz)	16,70
Noise level	68,00 dB



Catalogue

Chapter

Model

LMED-22 TP2 S 230V 1N 50/60Hz

19066875

10/02/2020

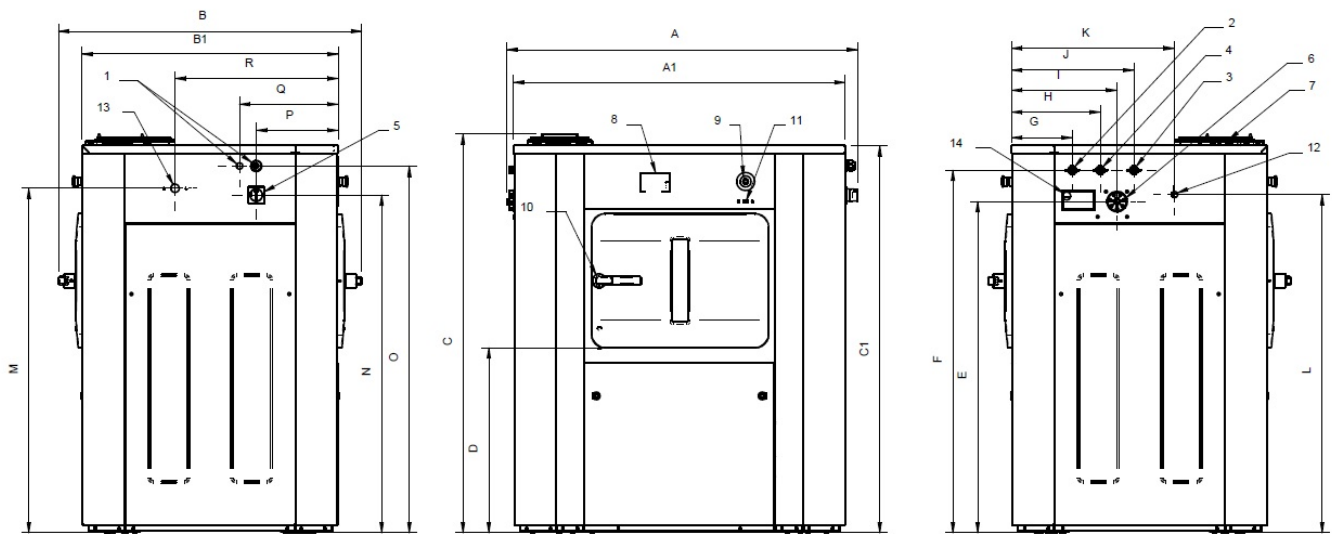

- 01. CONEXIÓN ELÉCTRICA
- 02. AGUA CALIENTE
- 03. AGUA FRÍA
- 04. AGUA DESCALCIFICADA
- 05. INTERRUPTOR GENERAL
- 06. ENTRADA PRODUCTOS LÍQUIDOS
- 07. JABONERA (OPCIÓN)
- 08. PANEL DE CONTROL
- 09. PARADA DE EMERGENCIA
- 10. APERTURA DE PUERTA
- 11. PUERTO USB
- 12. CONEXIÓN BOMBA DOSIFICADORA
- 13. ENTRADA VAPOR
- 14. SALIDA DE VAHOS

- 01. ELECTRICAL CONNEXION
- 02. HOT WATER
- 03. COLD WATER
- 04. SOFT WATER
- 05. MAIN SWITCH
- 06. LIQUID PRODUCTS INLET
- 07. DETERGENT BOX (OPTION)
- 08. CONTROL PANEL
- 09. EMERGENCY STOP
- 10. DOOR OPENING
- 11. USB PORT
- 12. DOSING PUMPS CONNEXION
- 13. STEAM INLET
- 14. EXHAUST

- 01. CONNEXION ELECTRIQUE
- 02. EAU CHAUDE
- 03. EAU FROIDE
- 04. EAU ADOUCIE
- 05. INTERRUPTEUR GENERAL
- 06. ENTREE PRODUITS LIQUIDES
- 07. BAC A PRODUITS (OPTION)
- 08. PANNEAU DE COMMANDE
- 09. ARRET D'URGENCE
- 10. OUVERTURE PORTE
- 11. PORT USB
- 12. CONNEXION POMPES DOSEUSES
- 13. ENTREE VAPEUR
- 14. EVENT

	A	B	C	A1	B1	C1	D	E	F	G	H	I	J	K	L	M	N	O	P	Q	R
LMED-16	1.054	1.082	1.426	984	914	1.385	661	1.184	1.296	217	317	377	437	582	1.209	1.231	1.207	1.311	292	352	582
LMED-22	1.254	1.082	1.426	1.184	914	1.385	661	1.184	1.296	217	317	377	437	582	1.209	1.231	1.207	1.311	292	352	582